

BENCH MARK (236.52' NELSON AVE. SCHOOL DATUM)  
 SUBTRACT 3.08' FROM NELSON AVE.  
 SCHOOL DATUM TO GIVE U.S.C. & G.S.

NELSON AVE. PARK

NELSON AVE. SCHOOL

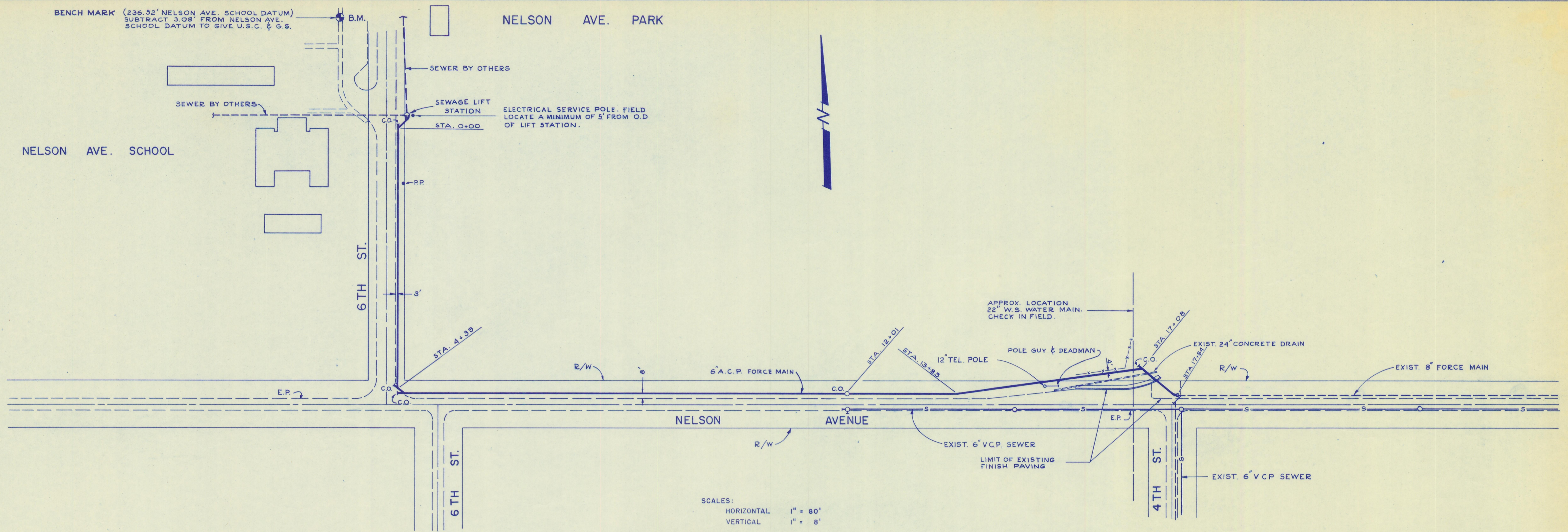

SCALES:  
 HORIZONTAL 1" = 80'  
 VERTICAL 1" = 8'

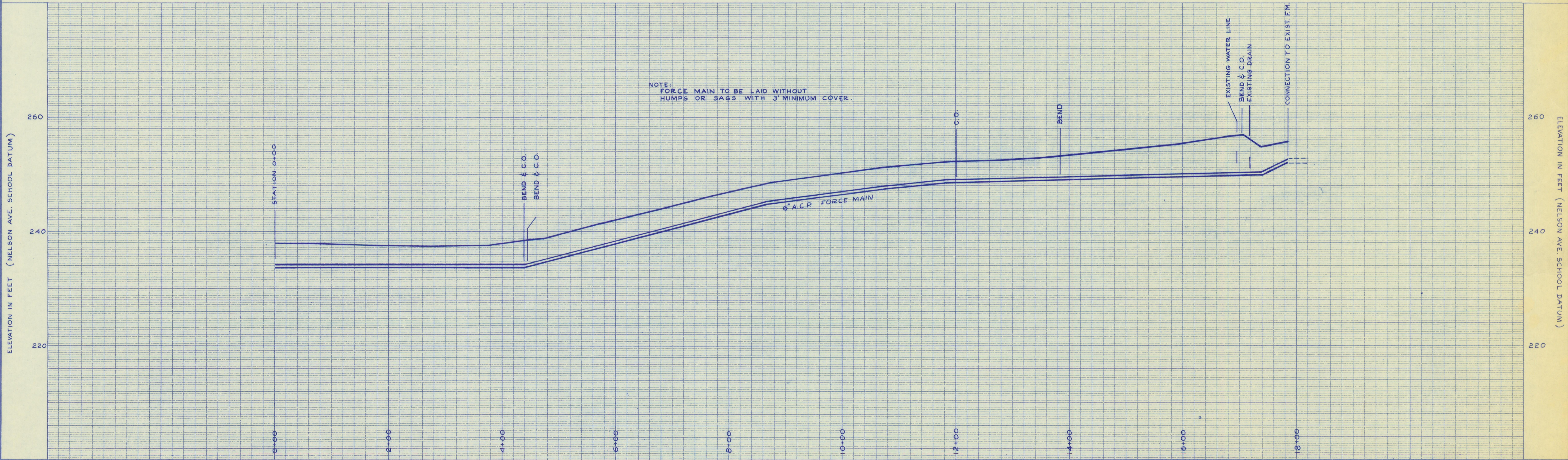

DEWANTE AND STOWELL  
 SANITARY AND CIVIL ENGINEERS - SACRAMENTO, CALIFORNIA.

REVISION	DATE	DESCRIPTION	BY	APPD.

SUBMITTED  
*Edwin R. Stowell*  
 APPROVED

THERMALITO UNION SCHOOL DISTRICT  
 NELSON AVENUE SCHOOL  
 BUTTE COUNTY, CALIFORNIA  
 SEWERAGE LIFT STATION & FORCE MAIN  
 FORCE MAIN - PLAN & PROFILE

DATE: JULY, 1963  
 SHEET NO. 3  
 OF 4

SS-248