

BENCH MARK
 1" ON CURB 10' WEST OF HYDRANT 62' RIGHT
 OF STATION 0+00, OROVILLE STATIONING
 ELEVATION 238.60

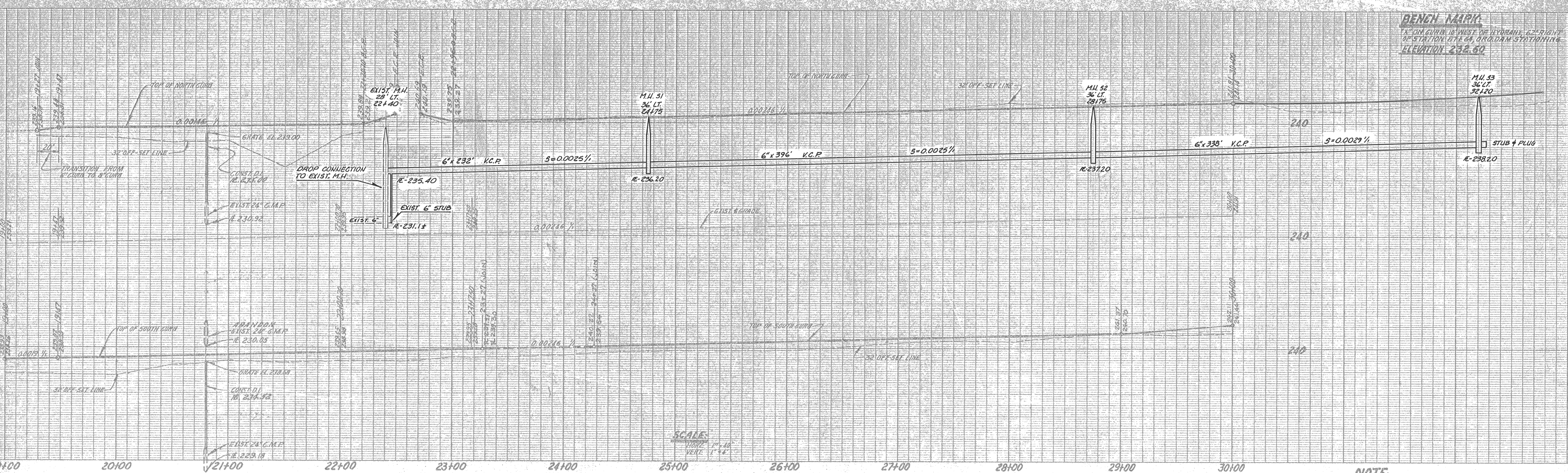

SCALE
 HORIZ. 1" = 40'
 VERT. 1" = 4'

NOTE:
 ALL WORK SHALL BE IN ACCORDANCE WITH THE CITY OF
 OROVILLE STANDARDS AND SPECIFICATIONS.

LATERAL FOR OLIVE HILL
 BAPTIST CHURCH DISCONNECTED
 FROM EXISTING SEWER ON WEST
 SIDE OF OLIVE HWY. & CONNECTED
 TO NEW LINE AT STA. 28+42

FRUIT STAND CONNECTED
 ON I-21-76 AT STA. 31+32

CURB RETURN DATA
 Δ-90°00'00"
 R-20.00'
 L-31.43'
 T-20.00'

CURB RETURN DATA
 Δ-90°00'00"
 R-20.00'
 L-31.43'
 T-20.00'

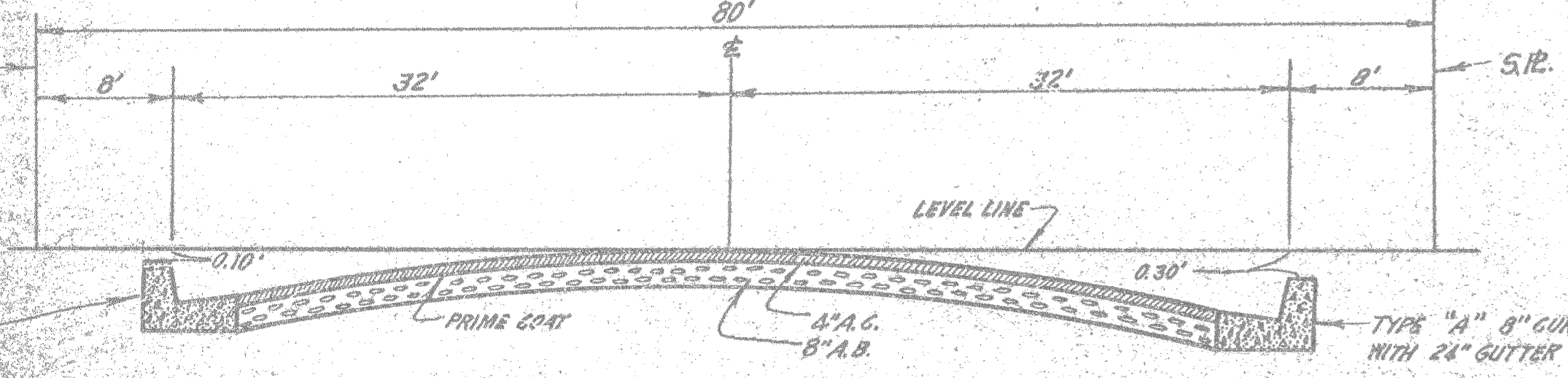
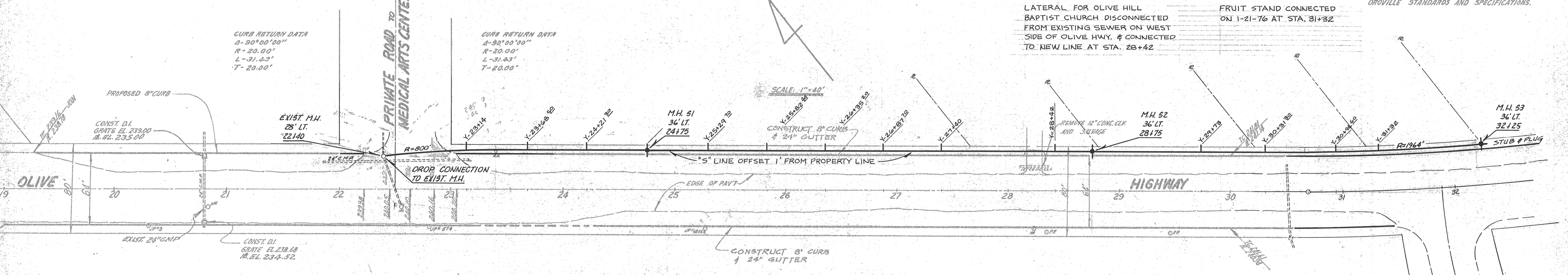

TYPICAL SECTION
 STA. 28+00 TO STA. 31+50

S LINE
 SEWER LINE EXTENSION
 OLIVE HIGHWAY
 12/4/76

REV	DATE	DESCRIPTION	APPD	BY
NO. 2	1/29/78	AS BUILT - "S" LINE		CEB
NO. 1	1/4/77	AS BUILT MEDICAL ARTS DRIVE WIDENED TO 40' CURB PAIS TO CURB FACE		GS

CITY of OROVILLE

PLAN AND PROFILE
 OF OLIVE HIGHWAY FROM
 1150 FEET SOUTH OF OROVILLE DAM BLVD
 TO 1000 FEET EAST OF CENTRAL DRIVE

DRAWN BY GS	APPROVED <i>Robert Jamborn</i> CITY ENGINEER	DATE 12/22/76
CHECKED BY <i>[Signature]</i>	GAS TAX PROJ. No. 64	

SS-263