



EXISTENCE AND LOCATION
ALL UTILITIES SHALL BE
VERIFIED BY THE CONTRACTOR.

AS BUILT
DATA

AS BUILT
DATA

NOTE

PACIFIC TELEPHONE AND
PG&E POWER (UNDERGROUND)
ARE LAID TIGHT TO MANHOLE

SURPLUS MATERIAL FROM STA. 20+25 (SHT. 8) TO STA. 46+20 (SHT. 10) SHALL BE DISPOSED
OF IN THE AREA SHOWN ABOVE. CONTRACTOR SHALL MAKE ARRANGEMENTS WITH OWNER
OF PROPERTY (MR. ARTHUR B. HATHI, 30011 SPRING AVE., OROVILLE, PHONE 534-8844)
NO CHARGE WILL BE MADE FOR USE OF THIS DISPOSAL AREA. COST OF DISPOSAL OF SURPLUS
MATERIAL WILL BE INCLUDED IN THE UNIT PRICE BID FOR PIPE AND NO ADDITIONAL ALLOWANCE
WILL BE MADE.

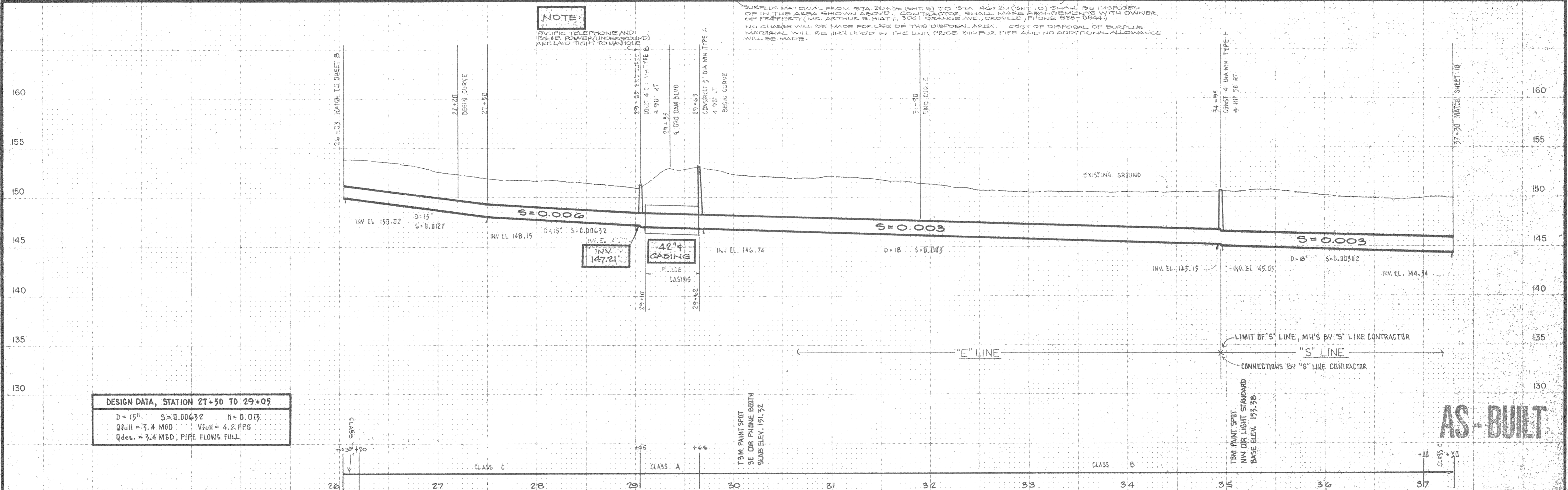

DESIGN DATA, STATION 27+50 TO 29+05
 D = 15" S = 0.00632 h = 0.017
 Q_{full} = 3.4 MGD V_{full} = 4.2 FPS
 Q_{des.} = 3.4 MGD, PIPE FLOW'S FULL

AS-BUILT

AS-BUILT

RINGEL & ASSOCIATES, INC



DES. EAR					
DR. W.K.J., G.B.					
CHK. G.B., W.K.J.					
APPR. <i>[Signature]</i>	NO.	DATE	REVISION	BY	APPD.

"E" LINE, "S" LINE

SEWERAGE COMMISSION,
OROVILLE REGION
OROVILLE, CALIFORNIA

PLAN AND PROFILE
SC-OR WEST INTERCEPTOR

SHEET
9 OF 20
DATE AUG. 1, 1974
PROJ. 2316
NO.