

GENERAL NOTES

1. ALL WORK SHALL CONFORM TO CITY OF GROVILLE SPECIFICATIONS AND ALL APPLICABLE LOCAL, COUNTY AND STATE CODES.
2. CONTRACTOR SHALL NOTIFY CITY OF GROVILLE ENGINEERS OFFICE 48 HOURS PRIOR TO STARTING WORK.
3. CONTRACTOR SHALL BE RESPONSIBLE FOR THE PROTECTION OF ALL EXISTING MONUMENTS AND OTHER SURVEY MARKERS DURING CONSTRUCTION. ALL SUCH MONUMENTS OR MARKINGS DESTROYED DURING CONSTRUCTION SHALL BE REPLACED AT CONTRACTOR'S EXPENSE.
4. CONTRACTOR SHALL BE RESPONSIBLE FOR CONTACTING THE VARIOUS UTILITY COMPANIES AS TO THE LOCATION OF ALL EXISTING UTILITIES PRIOR TO STARTING WORK.
5. TRENCH SAFETY PLANS- BEFORE BEGINNING EXCAVATION FOR A TRENCH FIVE FEET (5') OR MORE IN DEPTH, THE CONTRACTOR SHALL SECURE A PERMIT FROM THE CALIFORNIA DIVISION OF INDUSTRIAL SAFETY (555 RIO HINDS ROAD, CHICO, CALIFORNIA, PHONE 345-7131) A COPY OF THIS PERMIT MUST BE AVAILABLE AT THE CONSTRUCTION SITE.

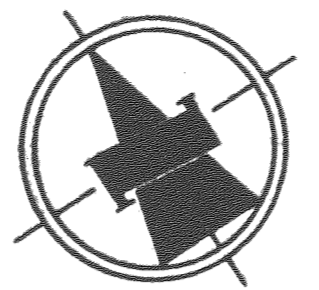

SCALE 1" = 20'

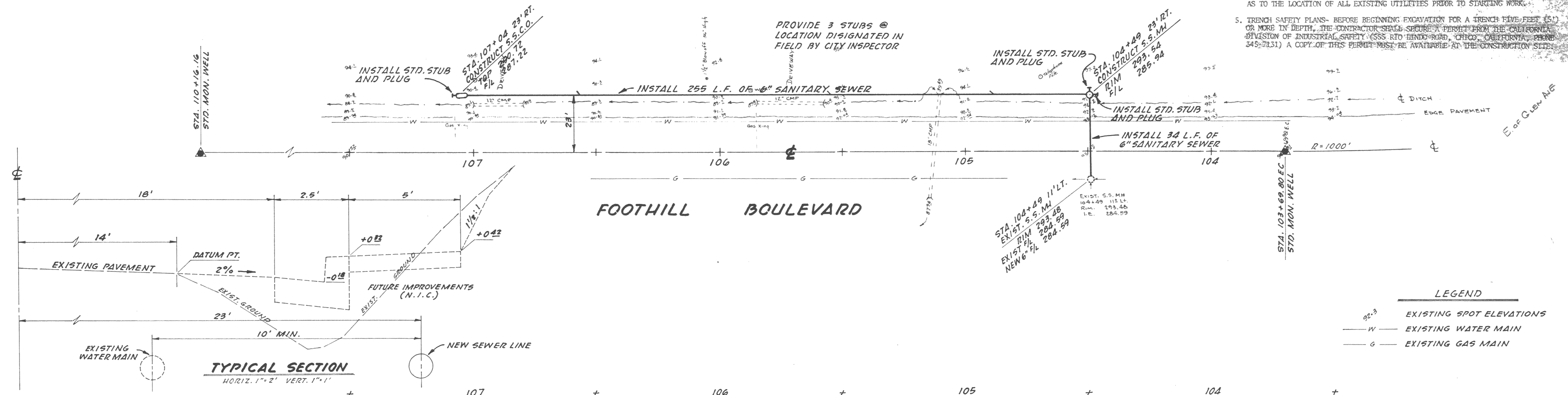

DATE	BY
SURVEYED	BY
ALIGNED	BY
CHECKED	BY
NO. OF WAY CHECKED	
NO.	

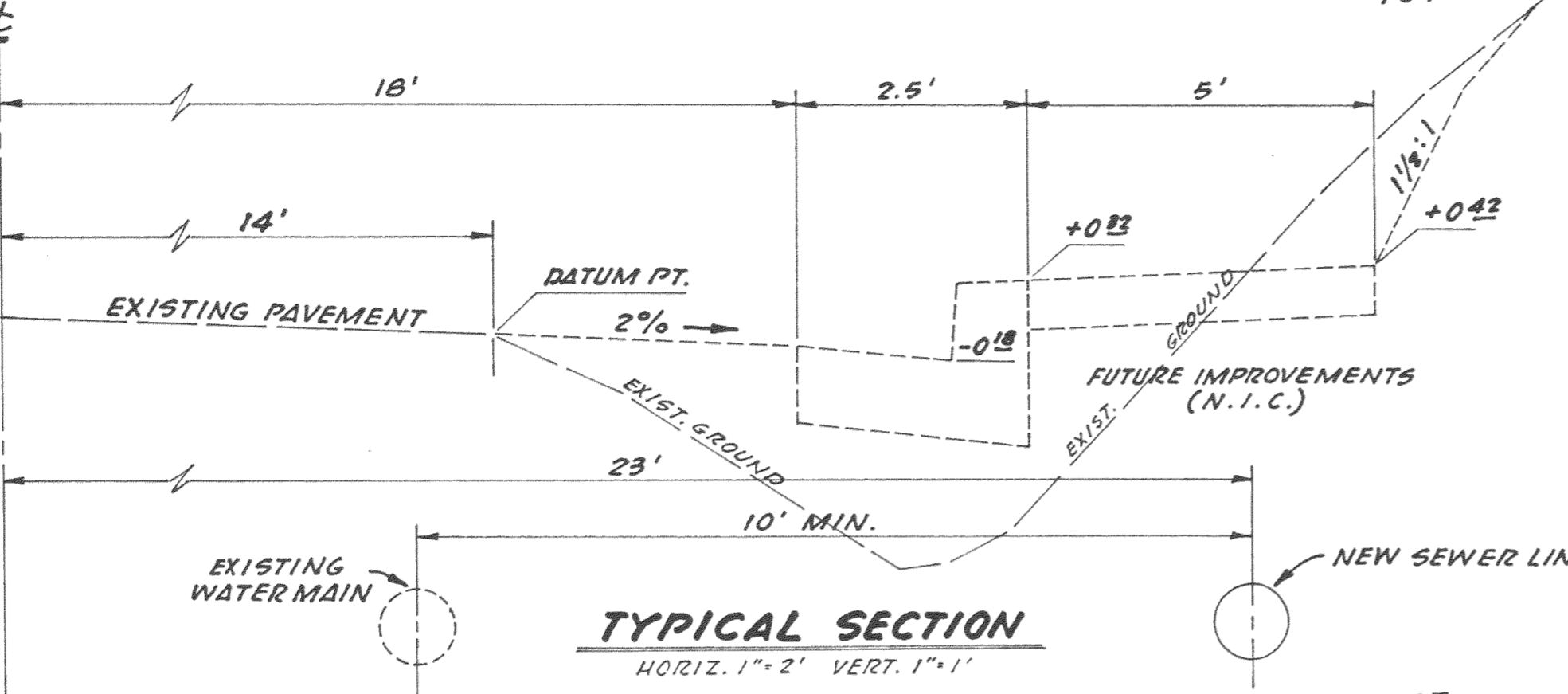

LEGEND

$\pm$	EXISTING SPOT ELEVATIONS
W	EXISTING WATER MAIN
G	EXISTING GAS MAIN

DATE	BY
SURVEYED	BY
ALIGNED	BY
CHECKED	BY
NO. OF WAY CHECKED	
NO.	

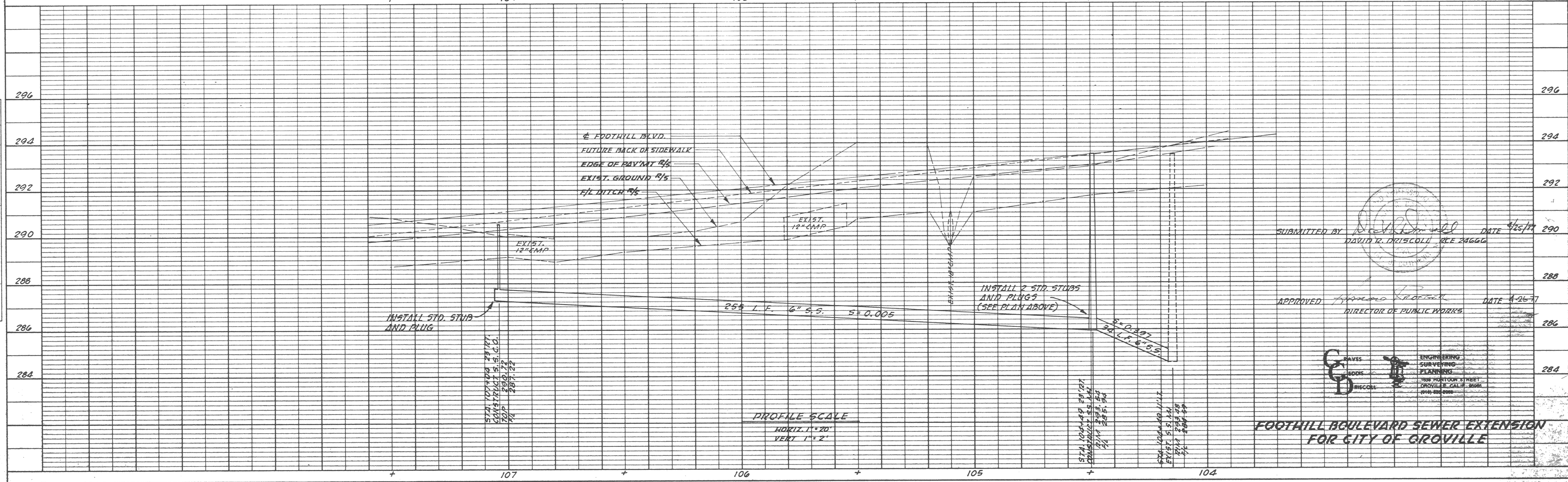

PROFILE SCALE  
HORIZ. 1" = 20'  
VERT. 1" = 2'

SUBMITTED BY *[Signature]* DATE 4/25/77  
DAVID R. DRISCOLL P.E. 24666

APPROVED *[Signature]* DATE 4-26-77  
DIRECTOR OF PUBLIC WORKS

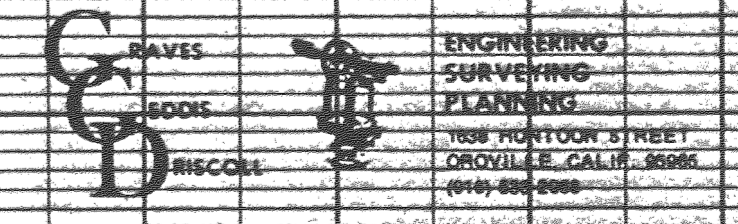

**FOOTHILL BOULEVARD SEWER EXTENSION  
FOR CITY OF GROVILLE**