

NOTES

1. THE EXISTANCE & LOCATION OF ALL UTILITIES SHALL BE VERIFIED BY THE CONTRACTOR.
2. CONTRACTOR TO VERIFY HOUSE SERVICE LOCATIONS AT TIME OF CONSTRUCTION.
3. EXTEND 4" SEWER SERVICES TO PROPERTY LINE.
4. ALL CONSTRUCTION SHALL BE IN STRICT CONFORMANCE WITH THE CITY OF ORVILLE STANDARDS & SPECIFICATIONS.
5. PRIOR TO BEGINNING OF CONSTRUCTION CALL 800-642-2444 FOR LOCATION OF EXISTING UTILITIES.

NOTE:
SEE MADRONE AVE. FILE FOR
DETAILS OF HOUSE CONNECTIONS.

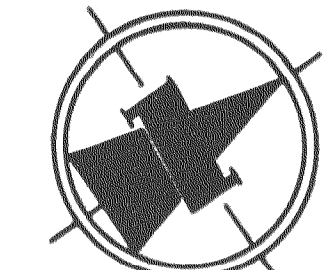

SCALE: 1"=20'

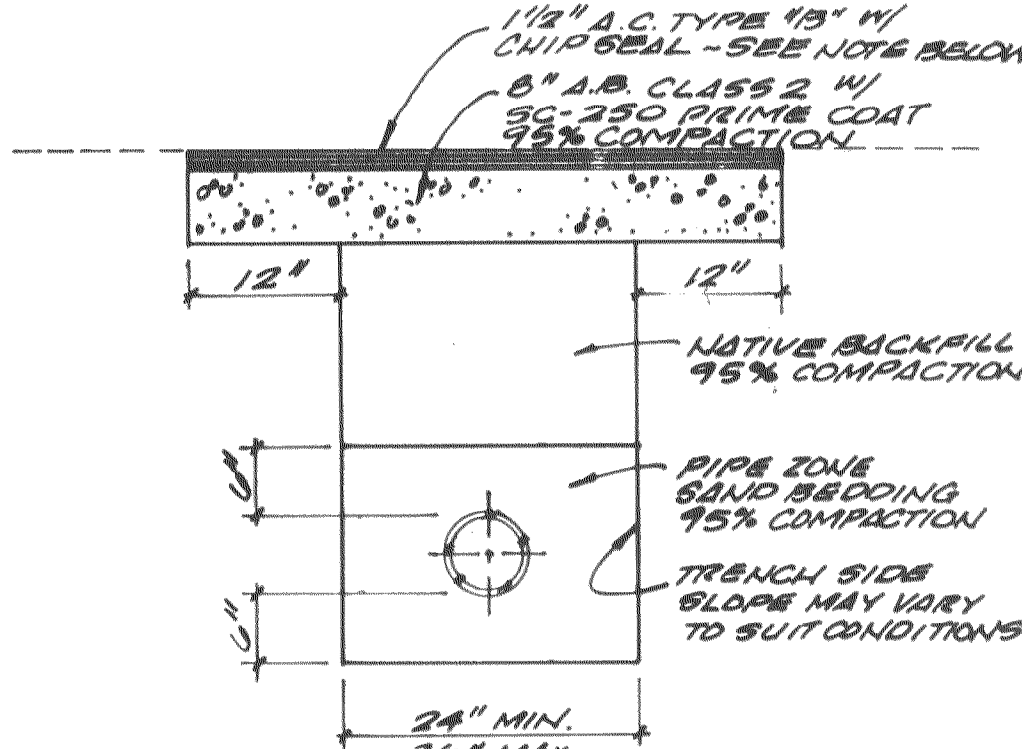
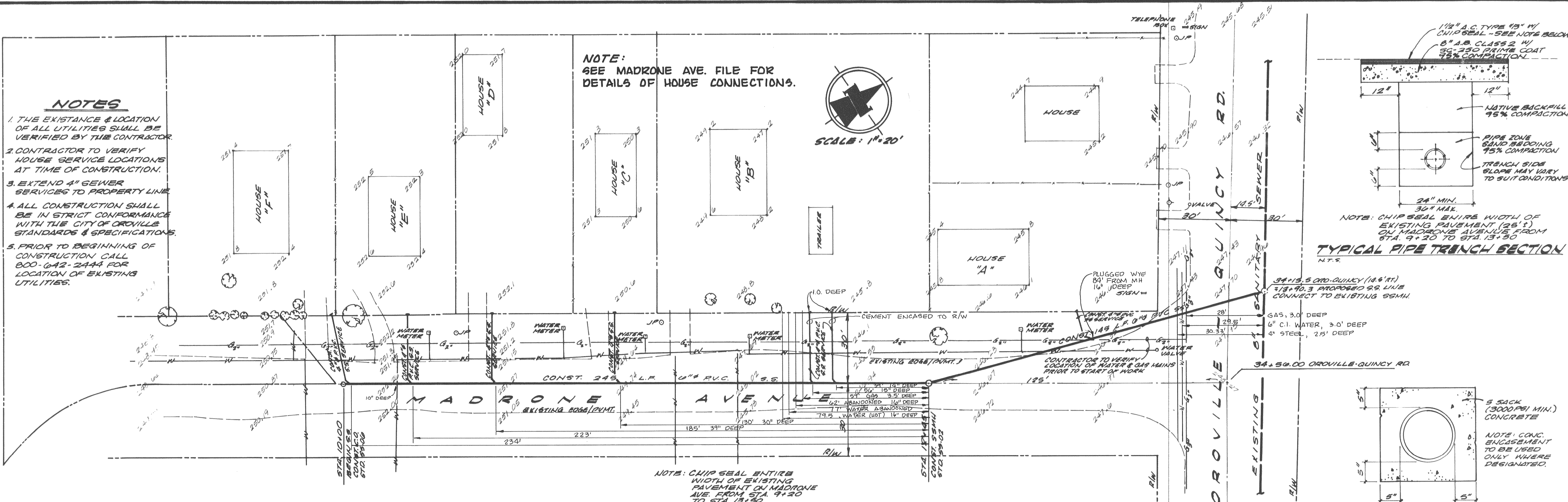

NOTE: CHIP SEAL ENTIRE WIDTH OF EXISTING PAVEMENT (25'±) ON MADRONE AVENUE FROM STA. 9+20 TO STA. 13+50

TYPICAL PIPE TRENCH SECTION
N.T.S.

NOTE: CHIP SEAL ENTIRE WIDTH OF EXISTING PAVEMENT ON MADRONE AVE. FROM STA. 9+20 TO STA. 13+50

