

B.M. 18 - ELEV. = 156.60
R.R. SPIKE ON 40" PALM, 4th PALM FROM SOUTH

B.M. 17 - ELEV. = 159.79
R.R. SPIKE ON 12" OAK

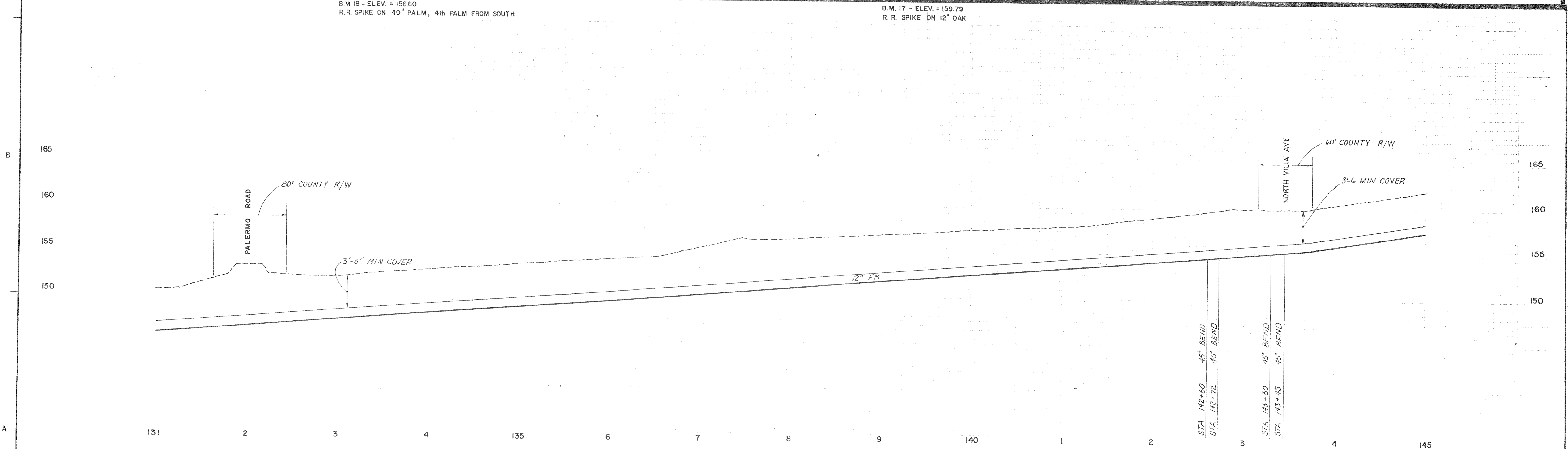

NUMBER	DATE	MADE BY	CHECKED BY	DESCRIPTION

DRAWN BY
D. Schlink

DEPT. CHECK

PROJ. CHECK
P. Smith

M&E METCALF & EDDY, INC. ENGINEERS
BOSTON • NEW YORK • PALO ALTO • CHICAGO

REG. PROF. ENGR.
Charles E. Powell

DATE
8/30/74

REG. PROF. ENGR.

SCALE:

HORIZONTAL 1" = 50'

VERTICAL 1" = 5'

UNLESS OTHERWISE NOTED OR CHANGED BY REPRODUCTION

PACIFIC COAST PRODUCERS
ORVILLE, CALIFORNIA

INDUSTRIAL WASTEWATER TREATMENT & DISPOSAL FACILITIES

FORCE MAIN - PLAN AND PROFILE
STA 131+00 TO STA 145+00

JOB _____

FILE NO. _____

SHEET C-5