

DATE: _____ BY: _____
 SUPERVISOR: _____
 CHECKED: _____
 DATE: _____

DATE: _____ BY: _____
 SUPERVISOR: _____
 CHECKED: _____
 DATE: _____

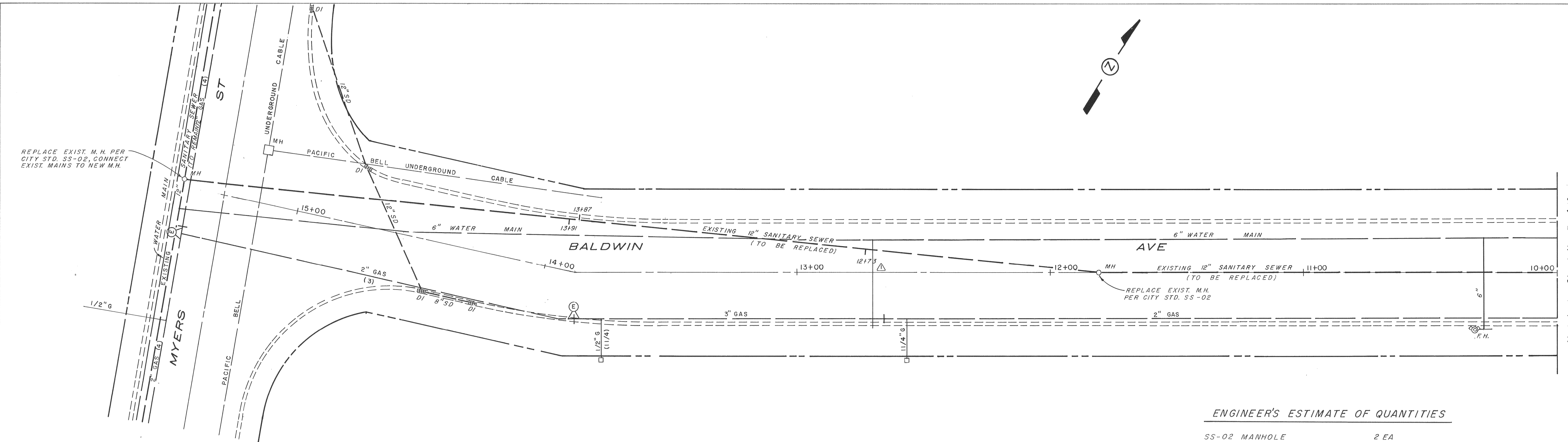

ENGINEER'S ESTIMATE OF QUANTITIES

SS-02 MANHOLE	2 EA
12" SANITARY SEWER MAIN	545 L.F
SS-01 SERVICE CONNECTIONS	2 EA
PAVEMENT REPLACEMENT	3180 SF

BENCHMARK
 TOP OF FIRE HYDRANT IN THE S.W. CORNER
 OF BALDWIN AVE & DARYL PORTER WAY
 ELEV. 194.82

SCALE
 HORIZ. 1" = 20'
 VERT. 1" = 2'

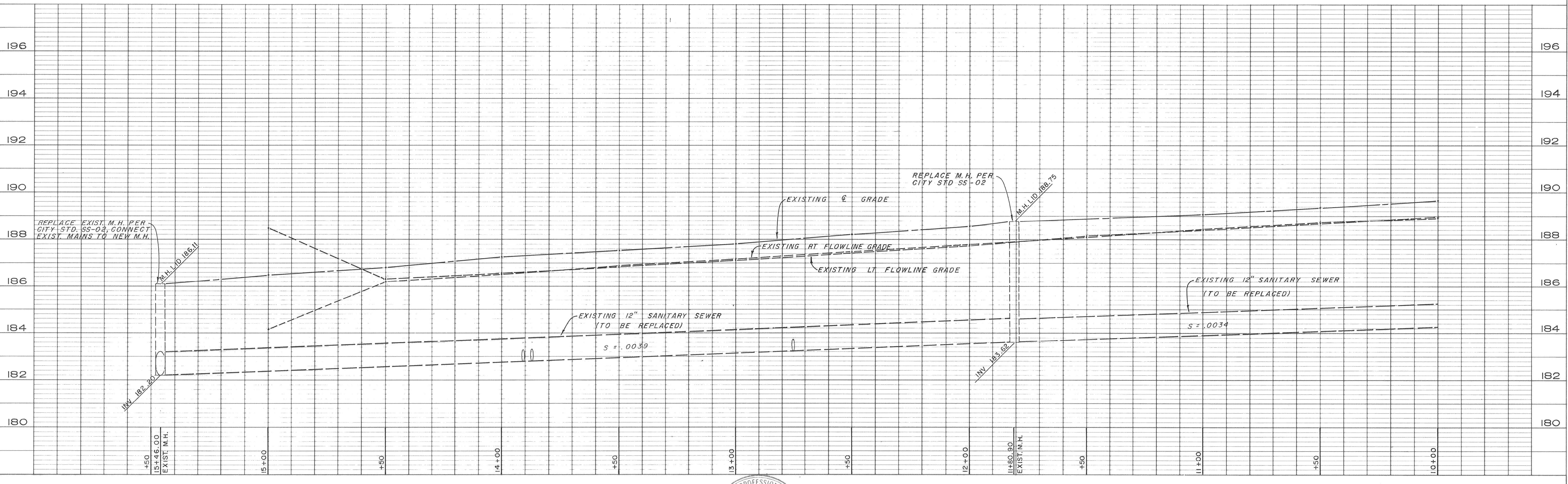

DATE NO.	REVISION	BY	APP'D
5-15-92	1	J.J.	J.J.

FIELD BOOK
 ELEVATION DATUM
 DRAWN T.F.
 DESIGNED J.J.
 CHECKED J.J.
 SCALE

APPROVED
 JOHN MICHAEL CRUIK
 No. C 041877
 EXP. 3/31/92
 CIVIL
 1/22/91
 DIRECTOR PUBLIC WORKS R.C.E. #1977 DATE



CITY OF OROVILLE
 PUBLIC WORKS DEPARTMENT
 1675 MONTGOMERY ST.
 OROVILLE, CA 95965 (916) 538-2420

SANITARY SEWER REPLACEMENT PROJECT
 BALDWIN AVENUE

AS-BUILT
 SHEET 4 OF 10
 SHEETS
 JOB NO. SS-337