

DATE: _____
 BY: _____
 SURVEYED: _____
 PLOTTED: _____
 PLAN: _____
 NOTE BOOK: _____
 NO. _____
 ALIGNMENT CHECKED: _____
 FIT OF SPAN CHECKED: _____

DATE: _____
 BY: _____
 SURVEYED: _____
 PLOTTED: _____
 PROFILE: _____
 NOTE BOOK: _____
 NO. _____
 GRADES CHECKED: _____
 STRUCTURE NOTATIONS CHECKED: _____

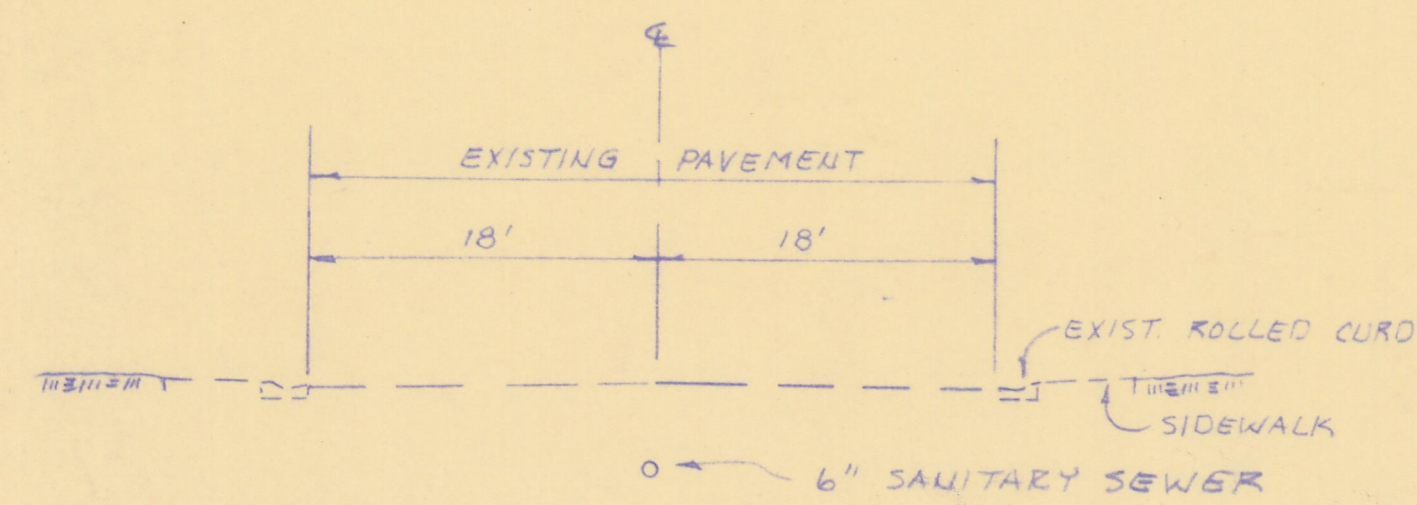

TYPICAL SECTION
ROCKRIDGE ROAD

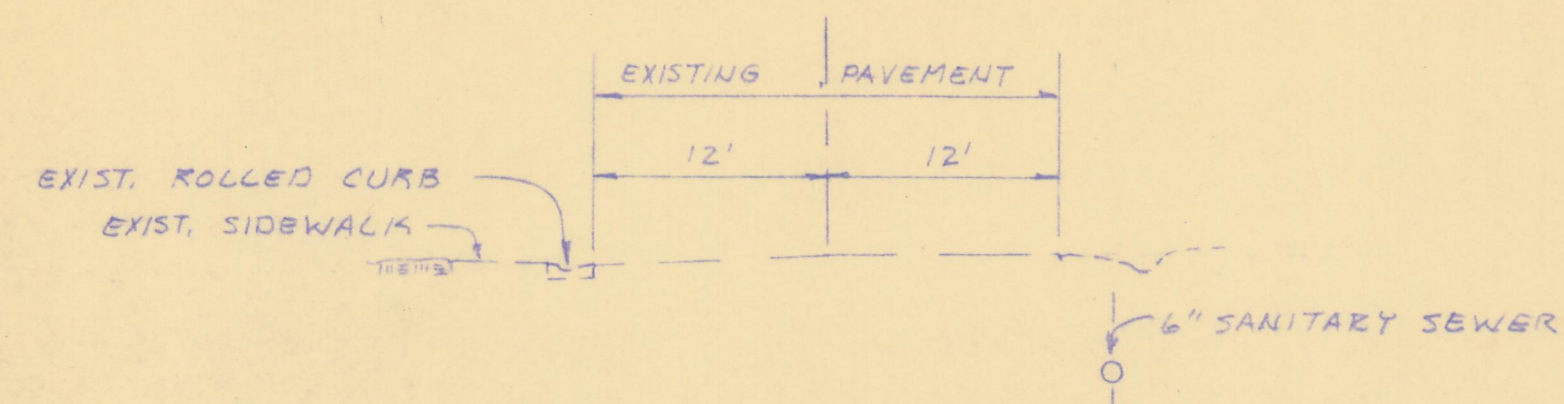

TYPICAL SECTION
HIGHLAND BLVD.

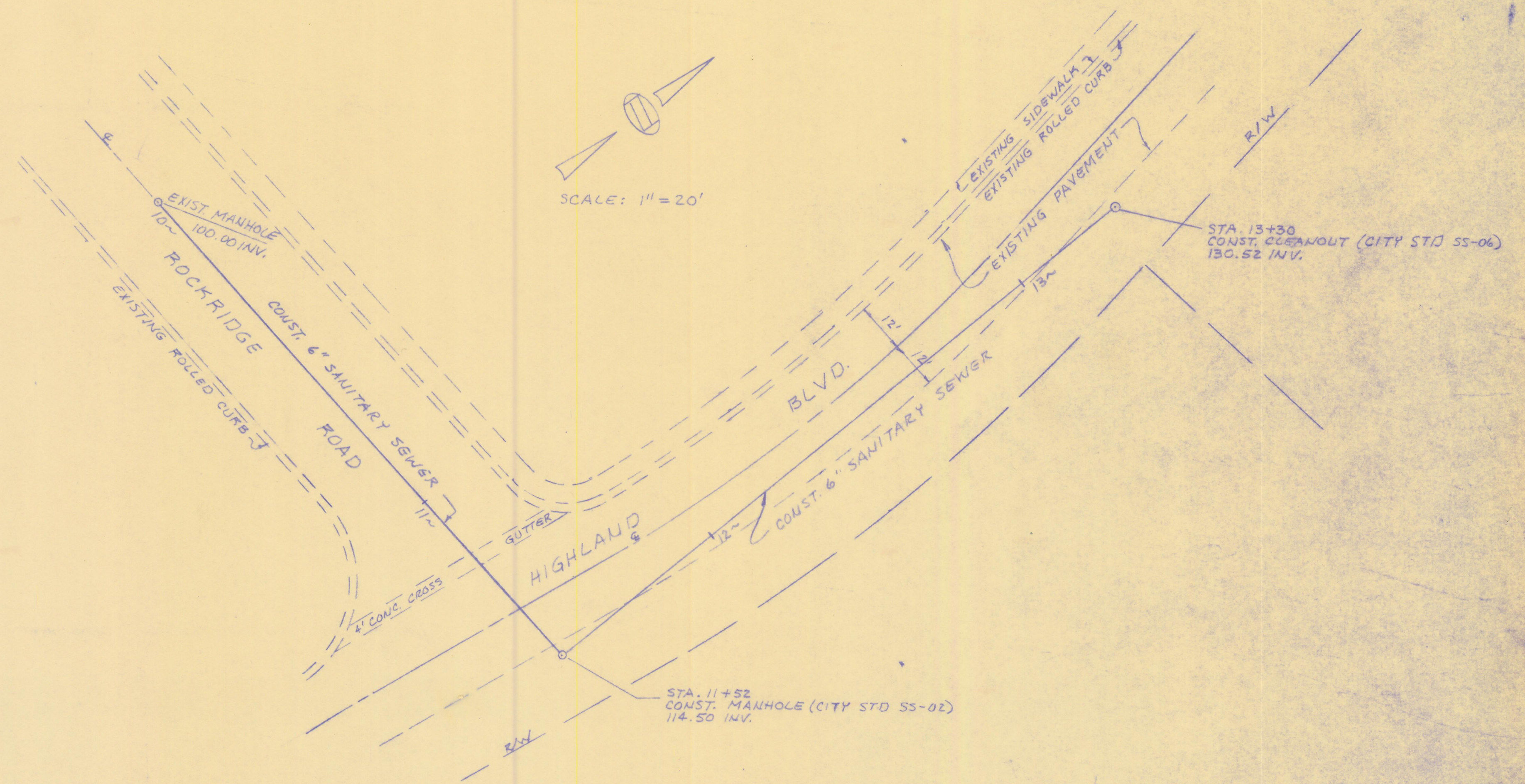

NOTES:

1. ALL CONSTRUCTION IS TO BE IN ACCORDANCE WITH CITY OF OROVILLE STANDARDS.
2. APPROVAL OF CITY OF OROVILLE REPRESENTATIVE IS REQUIRED PRIOR TO BACKFILL OF ALL TRENCHES.
3. CONTRACTOR IS TO AIR AND/OR WATER TEST NEW LINES AND MANHOLE IN THE PRESENCE OF A CITY OF OROVILLE REPRESENTATIVE.
4. AN ENCROACHMENT PERMIT MUST BE ACQUIRED FROM THE PUBLIC WORKS DEPT. PRIOR TO BEGINNING WORK.
5. CONSTRUCTION STAKING SHALL BE COMPLETED BY A LICENSED SURVEYOR. CUT SHEETS SHALL BE APPROVED BY THE CITY PRIOR TO BEGINNING WORK.
6. CONTRACTOR SHALL HAVE A CLASS A LICENSE.

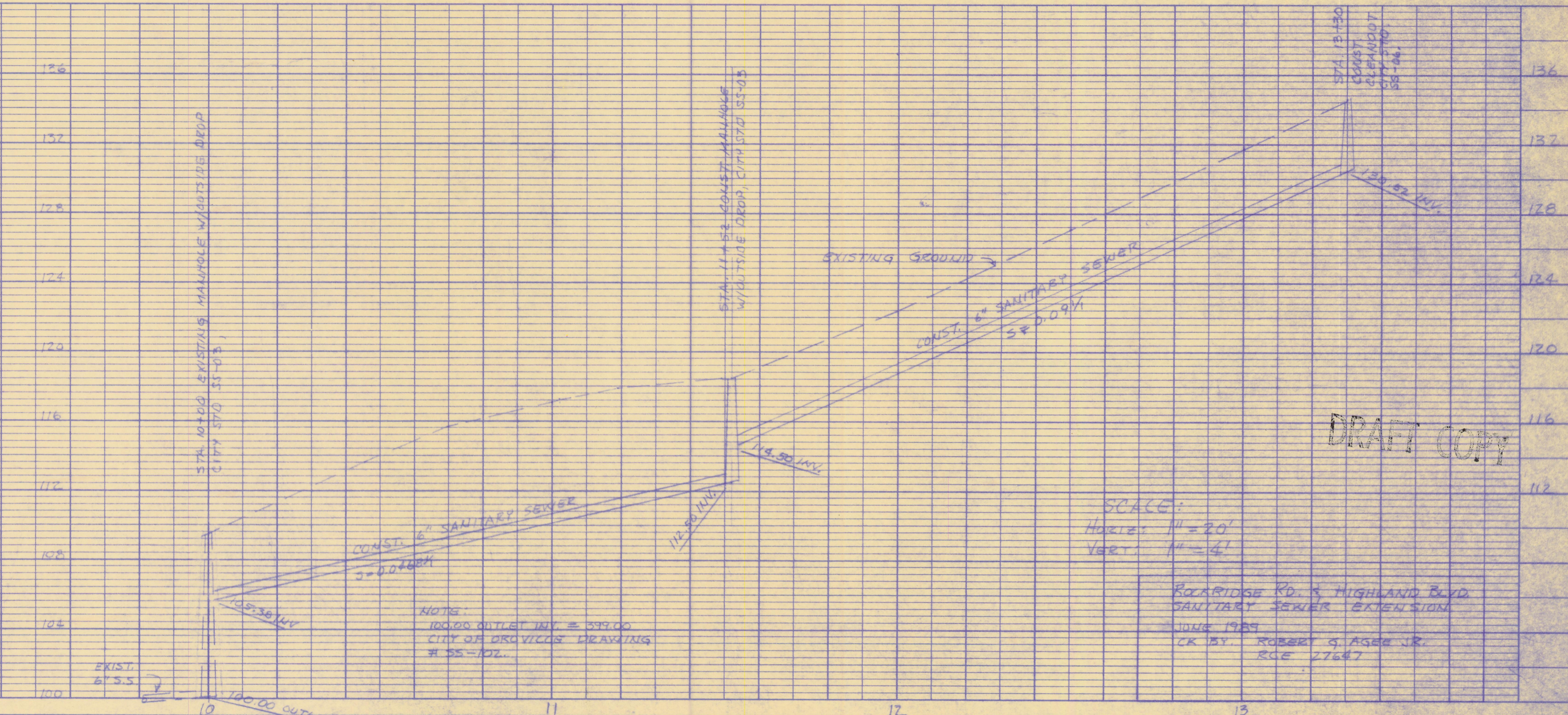

DRAFT COPY

SCALE:
 Horiz. 1" = 20'
 Vert. 1" = 4'

ROCKRIDGE RD. & HIGHLAND BLVD.
 SANITARY SEWER EXTENSION
 JUNE 1989
 CK BY: ROBERT G. ASER JR.
 RCE 27647

NOTE:
 100.00 OUTLET INV. = 539.00
 CITY OF OROVILLE DRAWING
 # 55-102.