

BENCH MARK:
 NAIL IN JP #607, 25 FEET RIGHT OF
 STATION 42+85 - CHICO ROAD
 ELEVATION 266.15 USGS DATUM

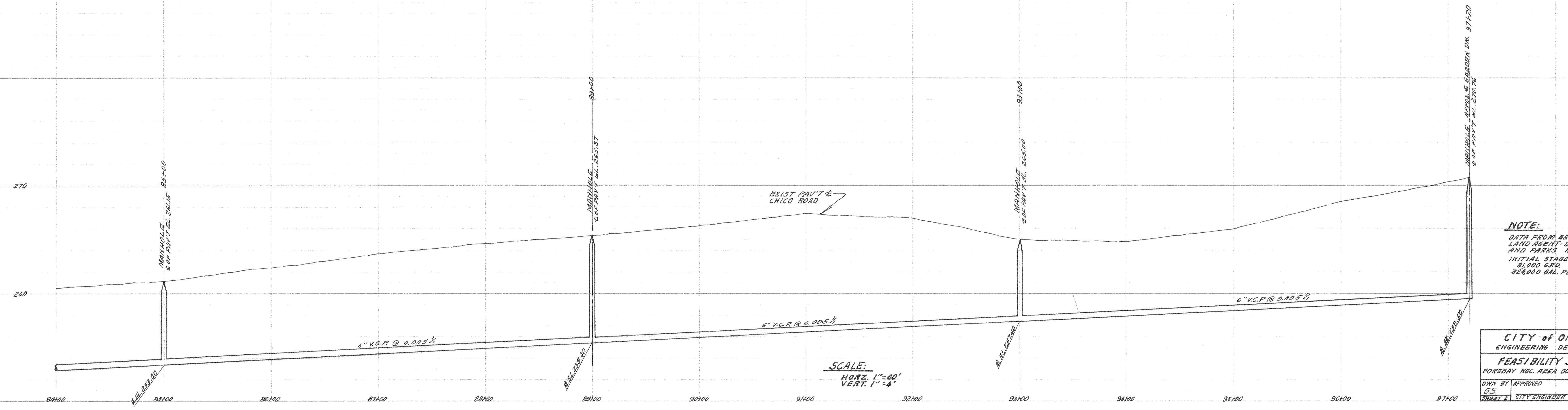
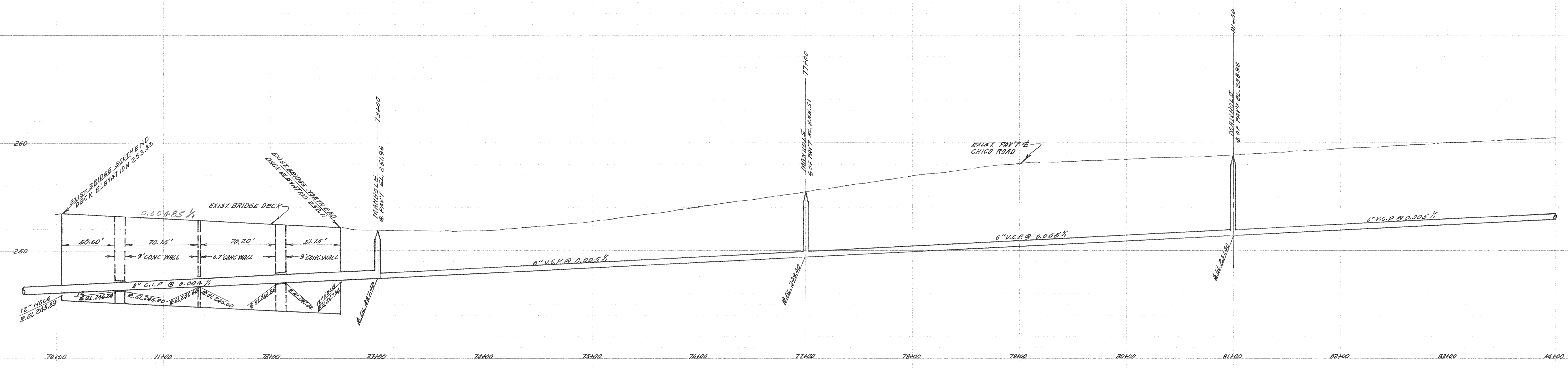

SCALE:
 HORZ. 1" = 40'
 VERT. 1" = 4'

NOTE:
 DATA FROM BERT WILEY
 LAND AGENT-DIV. OF BEACHES
 AND PARKS 12-29-66
 INITIAL STAGE:
 81,000 G.P.D.
 326,000 GAL. PEAK FLOW

CITY OF OROVILLE
 ENGINEERING DEPARTMENT
FEASIBILITY STUDY
 FOREBAY REG. AREA OUTFALL SAN SEWER
 DOWN BY APPROVED
 6-5
 SHEET 2 CITY ENGINEER RE: 11440 DATE