

PLAN  
 SURVEYED BY: \_\_\_\_\_ DATE: \_\_\_\_\_  
 PLOTTED BY: \_\_\_\_\_  
 NOTE BOOK No. \_\_\_\_\_  
 CHECKED BY: \_\_\_\_\_  
 STRUCTURE NOTATIONS CHECKED BY: \_\_\_\_\_

PROFILE  
 SURVEYED BY: \_\_\_\_\_ DATE: \_\_\_\_\_  
 PLOTTED BY: \_\_\_\_\_  
 NOTE BOOK No. \_\_\_\_\_  
 CHECKED BY: \_\_\_\_\_  
 STRUCTURE NOTATIONS CHECKED BY: \_\_\_\_\_

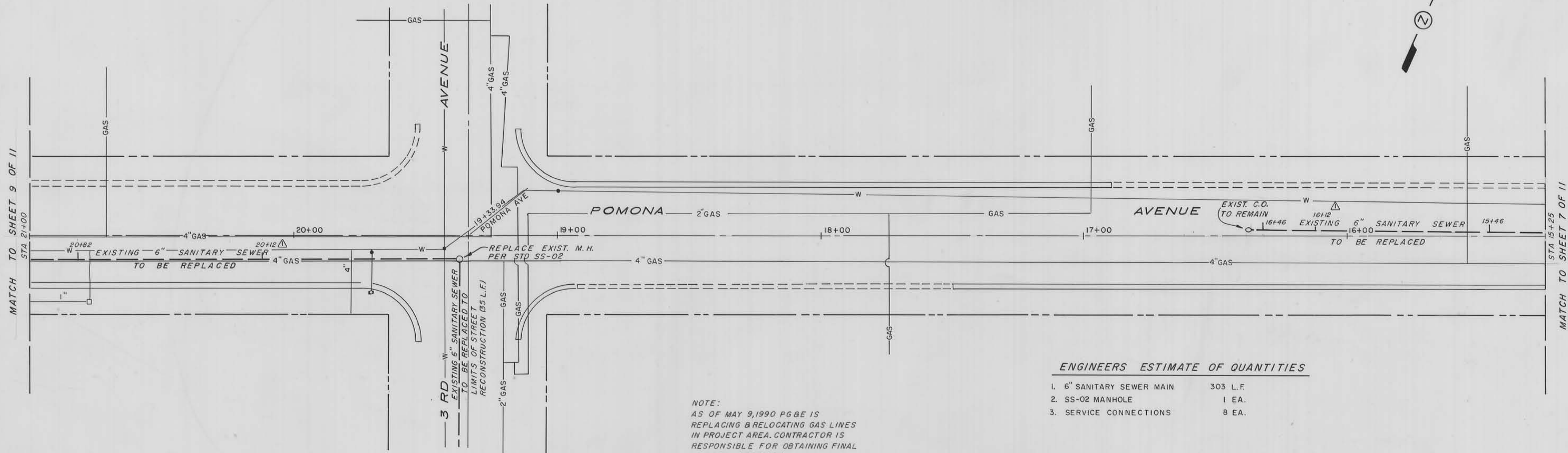

**ENGINEERS ESTIMATE OF QUANTITIES**

- 1. 6" SANITARY SEWER MAIN 303 L.F.
- 2. SS-02 MANHOLE 1 EA.
- 3. SERVICE CONNECTIONS 8 EA.

NOTE:  
 AS OF MAY 9, 1990 PG 8E IS  
 REPLACING & RELOCATING GAS LINES  
 IN PROJECT AREA. CONTRACTOR IS  
 RESPONSIBLE FOR OBTAINING FINAL  
 UTILITY LOCATIONS.

SCALE  
 HORIZ. 1" = 20'  
 VERT. 1" = 1'

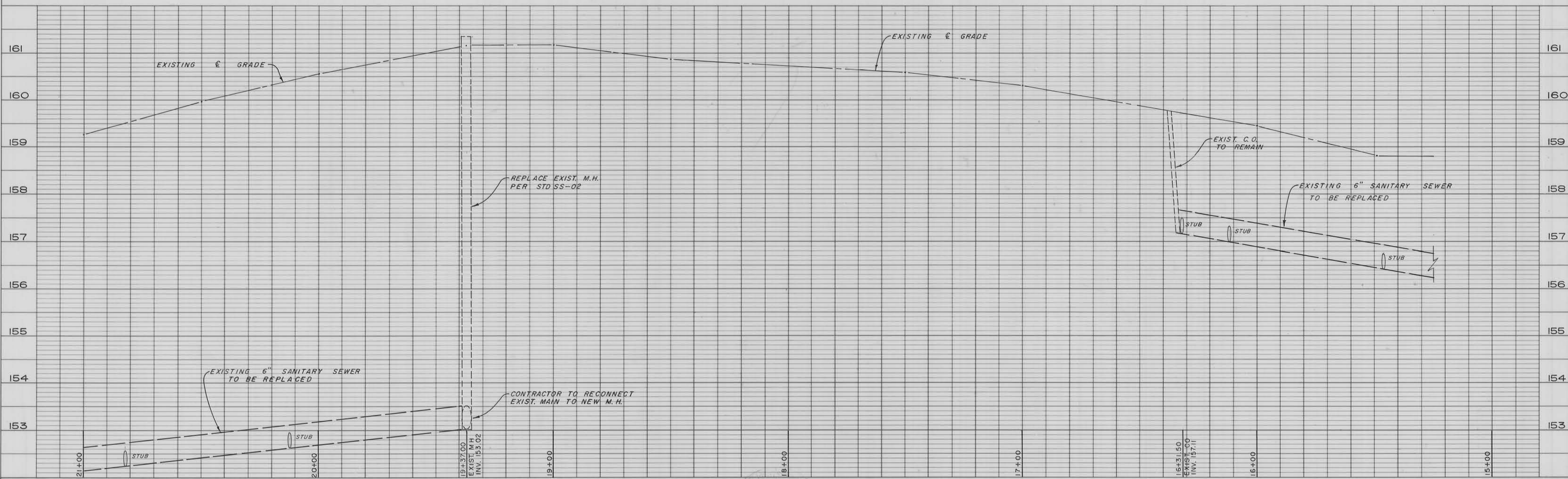

DATE NO.	REVISION	BY APP'D
5-19-92	▲ SANITARY SEWER STUB LOCATION	T.F. J.J.

FIELD BOOK
ELEVATION DATUM

DRAWN T.F.
DESIGNED J.J.
CHECKED J.J.
SCALE

APPROVED  
  
 REGISTERED PROFESSIONAL ENGINEER  
 MICHAEL GRUMP  
 No. C 041977  
 Exp. 3/1/95  
 DATE 5/19/92  
 DIRECTOR PUBLIC WORKS

CITY OF OROVILLE  
 PUBLIC WORKS DEPARTMENT  
 1675 MONTGOMERY ST.  
 OROVILLE, CA 95965 (916) 538-2420

SANITARY SEWER REPLACEMENT  
 PROJECT  
 POMONA AVENUE

AS-BUILT  
 SHEET  
**8** OF 11  
 SHEETS  
 JOB NO.