

IMPROVEMENT PLANS FOR GEORGIA PACIFIC WAY SANITARY SEWER EXTENSION

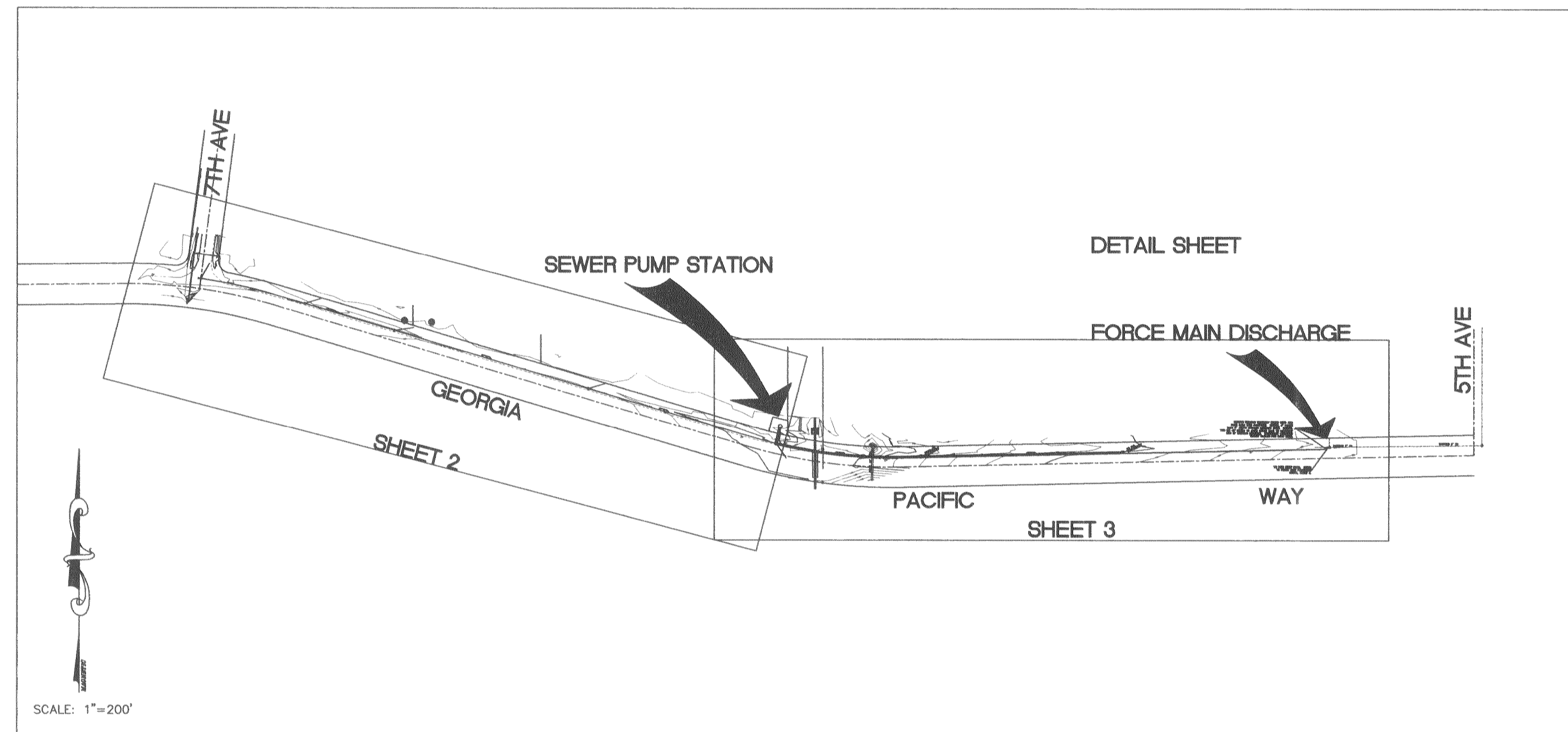

SHEET INDEX:

| DESCRIPTION | SHEET |
|---------------------------------------|-------|
| TITLE SHEET | 1 |
| PLAN AND PROFILE - STA: 9+00 - 21+00 | 2 |
| PLAN AND PROFILE - STA: 21+00 - 35+71 | 3 |
| DETAIL SHEET | 4 |
| SANITARY SEWER PUMP STATION | 5 |

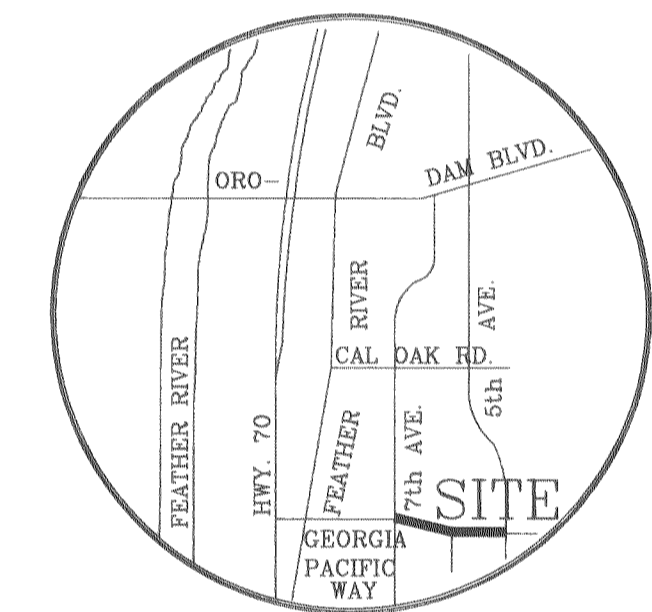

GENERAL NOTES

- ALL MATERIALS AND CONSTRUCTION SHALL CONFORM TO BUTTE COUNTY STANDARDS, THESE PLANS AND SPECIFICATIONS AND RELATED CONTRACT DOCUMENTS, STATE OF CALIFORNIA DEPARTMENT OF TRANSPORTATION STANDARD PLANS AND SPECIFICATIONS (LATEST EDITION) AND CHAPTER 70 OF THE UNIFORM BUILDING CODE (LATEST EDITION).
 - IT IS THE RESPONSIBILITY OF THE GENERAL CONTRACTOR TO COORDINATE THE WORK OF ANY SUBCONTRACTORS OR BUILDING CONTRACTORS AND UTILITY AGENCIES WITH HIS WORK AND TO ADHERE TO THE ORDER OF WORK IN THE SPECIFICATIONS.
 - CONTRACTOR SHALL BE SOLELY AND COMPLETELY RESPONSIBLE FOR CONDITION OF PREMISES ON WHICH THE WORK IS PERFORMED AND THE SAFETY OF THE PERSONS AND PROPERTY ON THE SITE BOTH DURING AND OUTSIDE OF NORMAL HOURS, UNTIL SUCH WORK IS ACCEPTED BY THE OWNER.
 - ALL UNSUITABLE AND SURPLUS MATERIAL SHALL BECOME THE PROPERTY OF THE CONTRACTOR AND SHALL BE REMOVED FROM THE SITE UNLESS THE OWNER SPECIFIES OTHERWISE.
 - THE TYPE, LOCATIONS, SIZES AND/OR DEPTHS OF EXISTING UNDERGROUND UTILITIES AS SHOWN ON THESE IMPROVEMENT PLANS WERE OBTAINED FROM SOURCES OF VARYING RELIABILITY. THE CONTRACTOR IS CAUTIONED THAT ONLY ACTUAL EXCAVATION WILL REVEAL THE TYPES, EXTENT, SIZES, LOCATIONS AND DEPTHS OF SUCH UNDERGROUND UTILITIES. A REASONABLE EFFORT HAS BEEN MADE TO LOCATE AND DELINEATE ALL KNOWN UNDERGROUND UTILITIES. HOWEVER, GDA CAN ASSUME NO RESPONSIBILITY FOR THE COMPLETENESS OR ACCURACY OF ITS DELINEATION OF SUCH UNDERGROUND UTILITIES NOR FOR THE EXISTENCE OF OTHER BURIED OBJECTS OR UTILITIES WHICH MAY BE ENCOUNTERED BUT WHICH ARE NOT SHOWN ON THESE DRAWINGS. THE CONTRACTOR IS HEREBY NOTIFIED THAT PRIOR TO COMMENCING CONSTRUCTION, HE IS RESPONSIBLE FOR CONTACTING THE UTILITY COMPANIES INVOLVED AND REQUESTING A VERIFICATION AT THE CONSTRUCTION SITE OF THE LOCATION OF THEIR UNDERGROUND UTILITIES WHERE SUCH FACILITIES MAY CONFLICT WITH THE PLACEMENT OF IMPROVEMENTS AS SHOWN ON THESE IMPROVEMENT PLANS.
 - CONTRACTOR SHALL CONTACT U.S.A. (1-800-642-2444) PRIOR TO START OF ANY CONSTRUCTION.
 - CONTRACTOR TO CONTACT BUTTE COUNTY, DEPARTMENT OF PUBLIC WORKS, 24 HOURS PRIOR TO START OF WORK.
 - APPROVAL OF BUTTE COUNTY DEPARTMENT OF PUBLIC WORKS IS REQUIRED ON COMPLETED WORK PRIOR TO:
 - PLACING OF ANY CONCRETE.
 - PLACING OF AGGREGATED BASE.
 - BACKFILLING TRENCHES FOR ANY UNDERGROUND WORK.
 - PLACING OF ASPHALTIC CONCRETE.
 WORK DONE WITHOUT SUCH APPROVAL SHALL BE DONE AT THE CONTRACTORS RISK. SUCH APPROVAL, WHEN GIVEN, SHALL NOT RELIEVE THE CONTRACTOR FROM THE RESPONSIBILITY OF PERFORMING THE WORK IN A ACCEPTABLE MANNER.
 - ALL EXISTING UTILITIES TO BE RELOCATED WILL BE RELOCATED AT CONTRACTOR'S EXPENSE, UNLESS NOTED OTHERWISE ON PLANS.
 - WHERE GDA IS TO PROVIDE CONSTRUCTION STAKES, SAID FIRM WILL ASSUME NO RESPONSIBILITY WHATSOEVER FOR IMPROVEMENTS CONSTRUCTED THEREFROM, UNLESS THE FOLLOWING PROCEDURE IS OBSERVED BY THE CONTRACTOR:
 - THE CONTRACTOR SHALL, THROUGH THE OFFICE OF GDA REQUEST CONSTRUCTION STAKES FOR ANY PARTICULAR PHASE OF THE WORK AT LEAST TWENTY-FOUR (24) HOURS PRIOR TO THE PLANNED USE OF SAID STAKES. NO REQUEST RECEIVED FROM A SUBCONTRACTOR WILL BE RECOGNIZED.
 - WHERE CONSTRUCTION STAKES ARE INTENDED FOR USE IN SETTING CONCRETE FORMS, THE CONTRACTOR SHALL, UPON COMPLETION OF FORM SETTING, CONTACT THE OFFICE OF GDA TO REQUEST A FORM CHECK.
 - WHERE GDA IS TO PROVIDE CONSTRUCTION STAKES, CONSTRUCTION STAKES FOR ALIGNMENT AND GRADE WILL BE FURNISHED TO THE CONTRACTOR ONE (1) TIME ONLY. THE SPACING AND OFFSET OF THE STAKES SHALL BE COORDINATED WITH GDA BY THE CONTRACTOR. STAKES AND MARKS SET BY GDA SHALL BE CAREFULLY PRESERVED BY THE CONTRACTOR. IN CASE SUCH STAKES AND MARKINGS ARE DESTROYED OR DAMAGED, THE COST OF REPLACING OR RESTORING THEM WILL BE DEDUCTED BY THE OWNER FROM ANY MONIES DUE OR TO BECOME DUE TO THE CONTRACTOR. REQUESTS FOR RESETTING LOST STAKES OR SETTING ADDITIONAL STAKES WILL BE ACKNOWLEDGED BY GDA ONLY WHEN AUTHORIZED BY THE OWNER. THE CONTRACTOR SHALL BE RESPONSIBLE FOR OBTAINING SUCH AUTHORIZATION.
 - THE CONTRACTOR SHALL OBTAIN ANY NEEDED PERMITS AT NO ADDITIONAL EXPENSE TO THE OWNER UNLESS OTHERWISE STATED IN THE CONTRACT DOCUMENTS.
 - ALL TESTING AND INSPECTIONS REQUIRED BY GOVERNING AGENCIES SHALL BE ARRANGED AND PAID FOR BY THE CONTRACTOR.
- GRAVING:
- THE CONTRACTOR SHALL REMOVE ALL OBSTRUCTIONS, VEGETATION AND DEBRIS BOTH ABOVE GROUND AND UNDERGROUND EXCEPT AS INDICATED ON THE PLANS, AS NECESSARY FOR THE CONSTRUCTION OF THE PROPOSED IMPROVEMENTS.
 - SUFFICIENT EQUIPMENT SHALL BE AVAILABLE TO PROVIDE DUST CONTROL AT ALL TIMES DURING EARTH MOVING OPERATIONS. AREAS SURROUNDING THE WORK SHALL BE KEPT CLEAN AND RETURNED TO ORIGINAL CONDITION UPON COMPLETION OF THIS CONTRACT.
 - ON SITE RELATIVE COMPACTION REQUIREMENTS:

| | |
|-----------------|---|
| STRUCTURAL FILL | - 95% BELOW TOP 12" |
| UNDISTURBED CUT | - SCARIFY TOP 6" (MINIMUM) AND COMPACT TO 95% |
| TRENCH BACKFILL | - 95% FOR TOP 12" BELOW SUBGRADE |
| | - 90% BELOW TOP 12" |

 UNLESS REDIRECTED BY CITY ENGINEER.
- CONTRACTOR SHALL BE RESPONSIBLE FOR THE PROTECTION OF ALL EXISTING MONUMENTS AND OTHER SURVEY MARKERS DURING CONSTRUCTION. ALL SUCH MONUMENTS AND MARKERS DESTROYED DURING CONSTRUCTION SHALL BE REPLACED AT CONTRACTORS EXPENSE.
 - PAVING CONTRACTOR TO BE RESPONSIBLE FOR ADJUSTING TO GRADE ALL VALVE BOXES AND BLOW-OFF VALVE BOXES FOR WATER DISTRIBUTION SYSTEMS, PLUS MANHOLES, CLEANOUTS, VAULTS, D.I.'S, ETC.
 - NO FILL MAY BE PLACED UNTIL THE EXPOSED SURFACES HAVE BEEN APPROVED BY THE SOILS ENGINEER AND THE OWNERS INSPECTOR.
 - ALL FILL AND BACKFILL MATERIAL MUST BE APPROVED BY THE SOILS ENGINEER AND THE OWNER.
 - IF ANY UNKNOWN SUBSURFACE STRUCTURES ARE ENCOUNTERED DURING CONSTRUCTION, THEY SHALL IMMEDIATELY BE BROUGHT TO THE ATTENTION OF THE SOILS ENGINEER AND THE OWNER PRIOR TO PROCEEDING.
 - PROTECTIVE MEASURES SHALL BE TAKEN BY THE CONTRACTOR TO PROTECT ADJACENT PROPERTIES, PUBLIC AND PRIVATE, AT ALL TIMES DURING CONSTRUCTION.
 - THE CONTRACTOR SHALL BE RESPONSIBLE FOR IMPORTING AND/OR EXPORTING ALL MATERIAL AS REQUIRED TO PROPERLY GRADE THIS SITE TO THE FINISHED ELEVATIONS SHOWN ON THE APPROVED PLANS.
 - PRIOR TO TRENCHING FOR THE CONSTRUCTION OF A NEW SEWER OR DRAIN, THE CONTRACTOR SHALL EXPOSE THE END OF ANY EXISTING SEWER OR DRAIN LINE SO THE ENGINEER MAY VERIFY THE LOCATION AND ELEVATION CONTRACTOR TO EXPOSE ANY EXISTING FACILITY AND CHECK FOR POSSIBLE CONFLICTS PRIOR TO START OF WORK.
 - TRENCH SAFETY PLANS: BEFORE BEGINNING EXCAVATION FOR A TRENCH FIVE FEET (5') OR MORE IN DEPTH, THE CONTRACTOR SHALL SECURE A PERMIT FROM THE CALIFORNIA DIVISION OF INDUSTRIAL SAFETY. A COPY OF THIS PERMIT MUST BE AVAILABLE AT THE CONSTRUCTION SITE.
 - ALTERNATE MATERIALS FOR STORM DRAIN PIPE WILL BE SUBMITTED TO THE OWNER AND BUTTE COUNTY FOR APPROVAL. SHOULD THE FLOW CHARACTERISTICS OF THE PROPOSED MATERIAL DIFFER FROM CONCRETE PIPE, THE DESIGN ENGINEER WILL VERIFY PROPOSED SIZES OF PIPE.
 - EXISTING STORM DRAIN PIPES NOTED TO BE ABANDONED, SHALL BE PLUGGED WITH A SACK CONCRETE MIX ON EACH END.
 - CONTRACTOR IS CAUTIONED ABOUT UNDERGROUND CONFLICTS. PRIOR TO START OF INSTALLATION OF ANY NEW UNDERGROUND UTILITY, CONTRACTOR SHALL EXPOSE EXISTING UTILITIES TO CHECK FOR VERTICAL AND/OR HORIZONTAL CONFLICTS. SHOULD CONFLICTS EXIST, CONTRACTOR TO NOTIFY ENGINEER/OWNER IMMEDIATELY.
 - ALL FITTINGS ON 4" PVC C900 FORCE MAIN SHALL BE DUCTILE IRON AND SHALL HAVE CONCRETE THRUST BLOCKS PER CITY STANDARDS.



Approved: *Charles L. Castellberry* Date: 2-22-00
 Clay Castellberry, RCE 14224 Exp. 3-30-00
 Acting Director Public Works
 City of Oroville

| | | | | | | | | |
|---|-----|----------|----------|--------|-------|----------|--|--|
| FIELD BOOK | | | DATE | 2/1/00 | | | GEORGIA PACIFIC WAY SANITARY SEWER EXTENSION TITLE SHEET CITY OF OROVILLE | SHEET 1 OF 5 SHEETS JOB NO. 99056 |
| ELEVATION DATUM | | | DRAWN | LFG | | | | |
| TOP OF HYDRANT ON WEST SIDE OF 5TH AVE. 60± SOUTH OF RAILROAD TRACKS. | | | DESIGNED | LFG | | | | |
| CITY OF OROVILLE DATUM: ELEV=159.96 | | | CHECKED | KCL | | | | |
| DATE | NO. | REVISION | BY | APP'D | SCALE | 1" = 40' | DATE | 2-19-00 |