

BENCH MARK:
 NAIL IN JP# 607, 25 FEET RIGHT OF
 STATION 42+85 - CHICO ROAD
 ELEVATION 266.15 USGS DATUM

SCALE:
 HORZ. 1" = 40'
 VERT. 1" = 4'

NOTE:
 DATA FROM BERT WILEY
 LAND AGENT-DIV OF BEACHES
 AND PARKS 12-29-66
 INITIAL STAGE:
 81,000 G.P.D.
 324,000 GAL. PEAK FLOW

CITY OF OROVILLE	
ENGINEERING DEPARTMENT	
FEASIBILITY STUDY	
FOREBAY REC. AREA OUTFALL SAN SEWER	
DWN BY	APPROVED
65	
SECRET	CITY ENGINEER RE 11440 DATE

MANUFACTURED BY
 THE ENGINEERING CENTER
 MADE IN U.S.A.

MANUFACTURED BY
 THE ENGINEERING CENTER
 MADE IN U.S.A.

MANUFACTURED BY
 THE ENGINEERING CENTER
 MADE IN U.S.A.

BENCH MARK:
 NAIL IN JP #607, 25 FEET RIGHT OF
 STATION 42+85 - CHICO ROAD
 ELEVATION 266.15 USGS DATUM

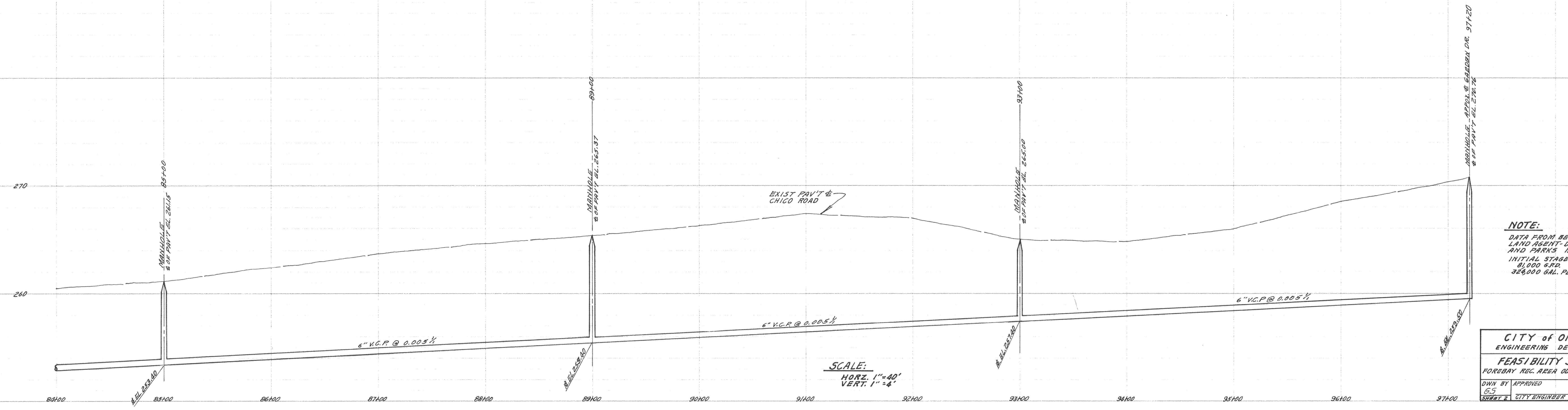
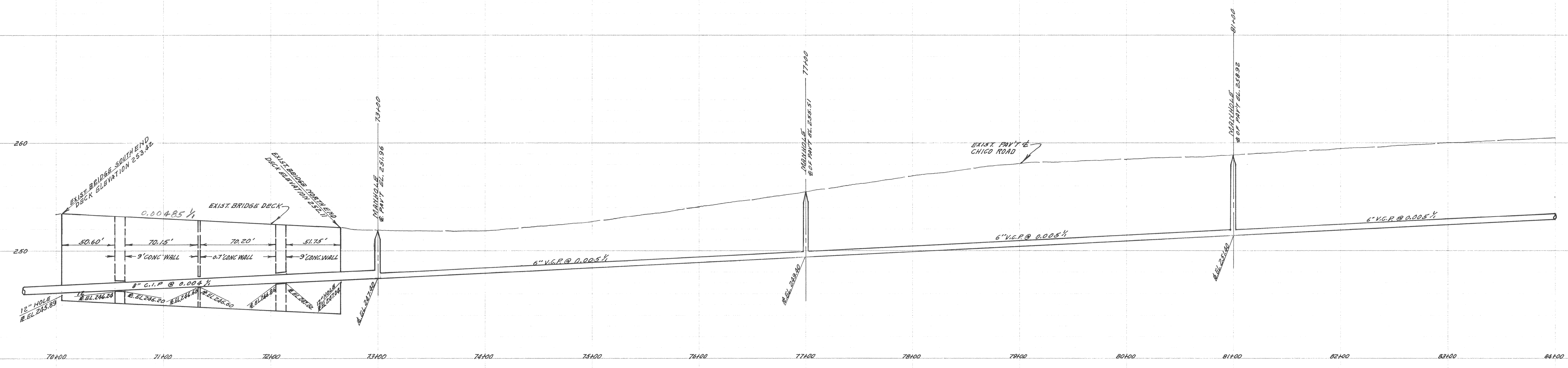

SCALE:
 HORZ. 1" = 40'
 VERT. 1" = 4'

NOTE:
 DATA FROM BERT WILEY
 LAND AGENT-DIV. OF BEACHES
 AND PARKS 12-29-66
 INITIAL STAGE:
 81,000 G.P.D.
 326,000 GAL. PEAK FLOW

CITY OF OROVILLE
 ENGINEERING DEPARTMENT
FEASIBILITY STUDY
 FOREBAY REG. AREA OUTFALL SAN SEWER
 DOWN BY APPROVED
 65
 SHEET 2 CITY ENGINEER RE 11440 DATE

100' x 100' x 100'

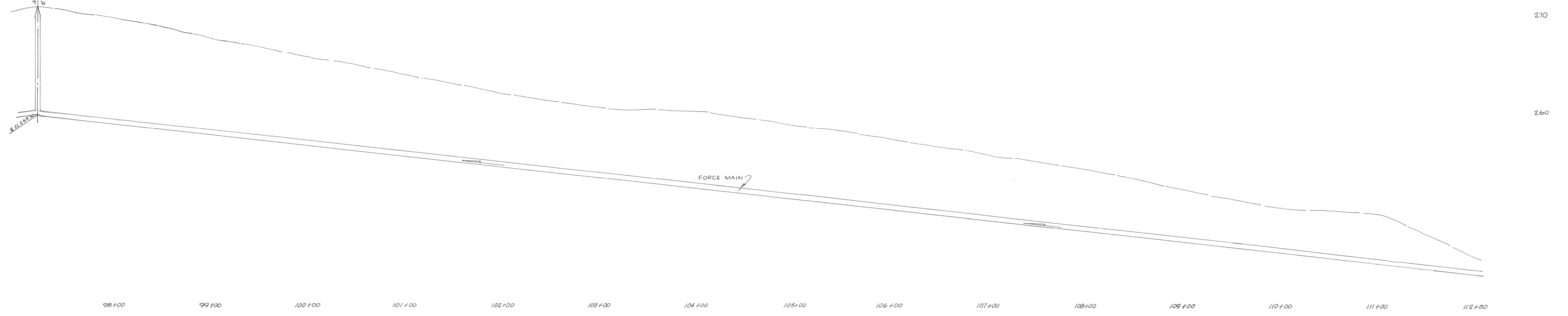

98+00 99+00 100+00 101+00 102+00 103+00 104+00 105+00 106+00 107+00 108+00 109+00 110+00 111+00 112+00

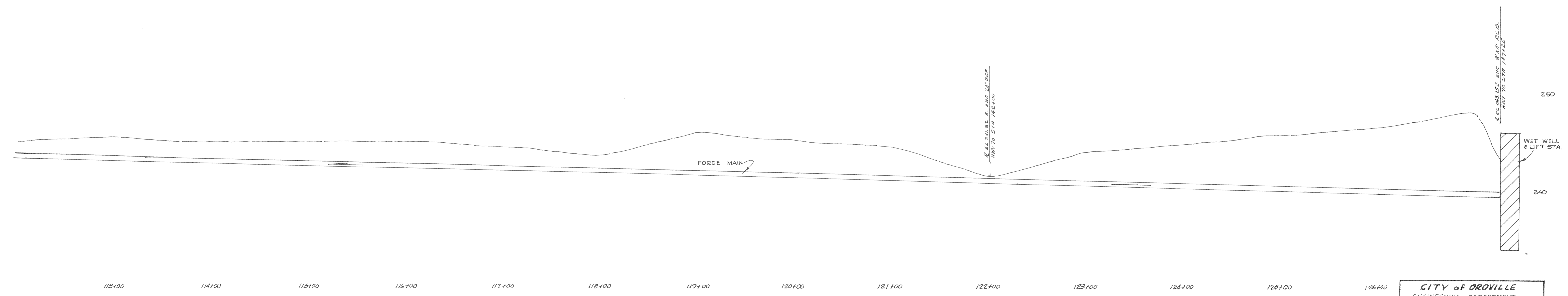

113+00 114+00 115+00 116+00 117+00 118+00 119+00 120+00 121+00 122+00 123+00 124+00 125+00 126+00

CITY OF OROVILLE	
ENGINEERING DEPARTMENT	
FEASIBILITY STUDY	
OWN BY	APPROVED
BY	DATE
SHEET	CITY ENGINEER RCE 11/4/00 DATE