

TYPICAL STUB AND DROP MANHOLE
SECTION - AA

6" MIN. COVER ON ALL SIDES
SLURRY CEMENT 19-3.062
OF CALTRANS STANDARD
SPECIFICATIONS

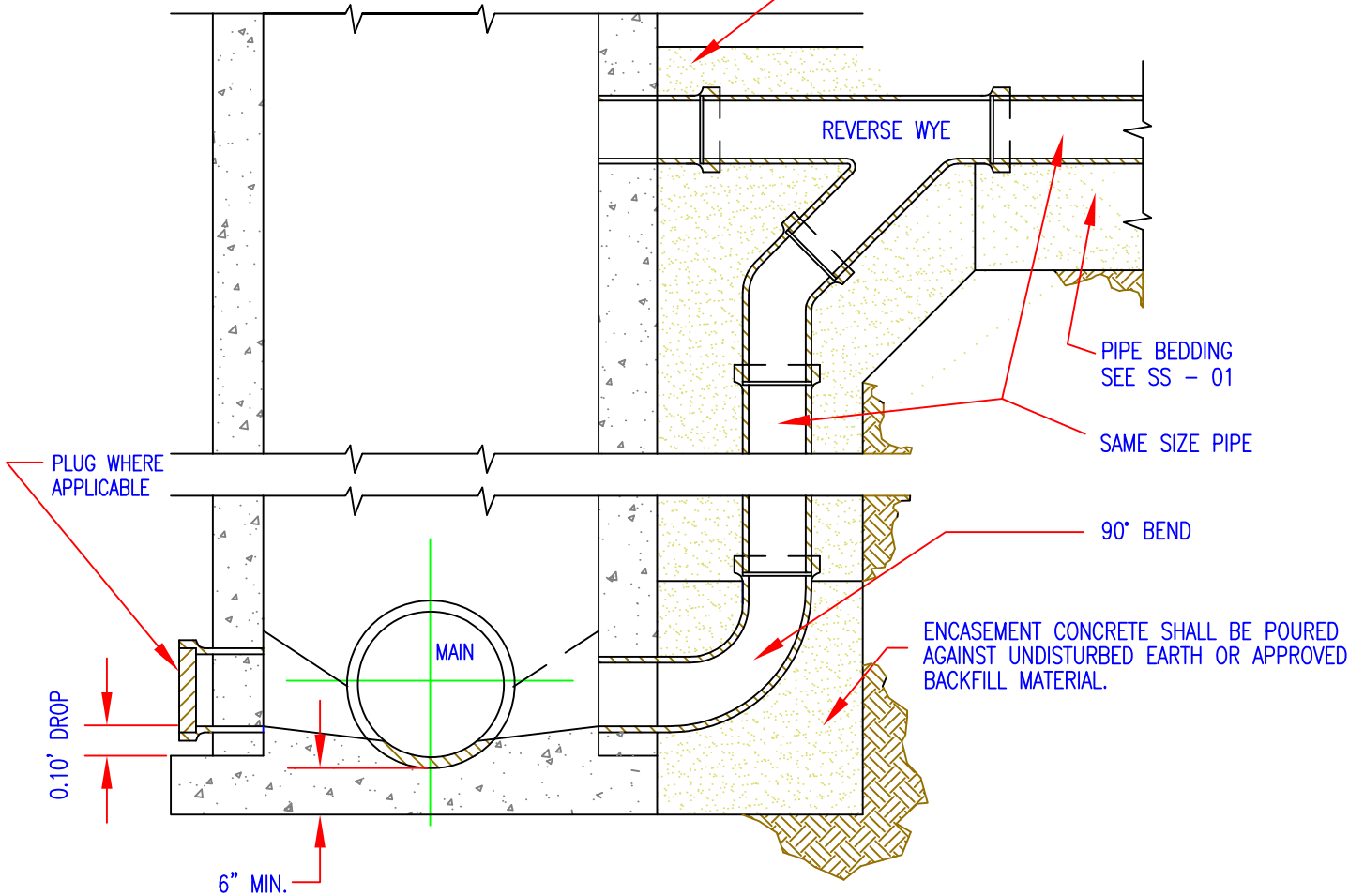

NOTES:

1. 90° BEND MAY BE CORED ABOVE BENCH TOP WITH PRIOR APPROVAL FROM ENGINEER IF A STUB DOES NOT EXIST IN EXISTING MANHOLE BASE.
2. WHEN POURING BASE IN PLACE, BENCH MUST TERMINATE BELOW SPRINGLINE.
3. BENCH SLOPE TO BE BETWEEN 20° AND 40°.
4. ALL PIPES SHALL BE CORE DRILLED AND SHALL BE A MINIMUM OF 2" IN DIA. LARGER THAN SAID PIPE.

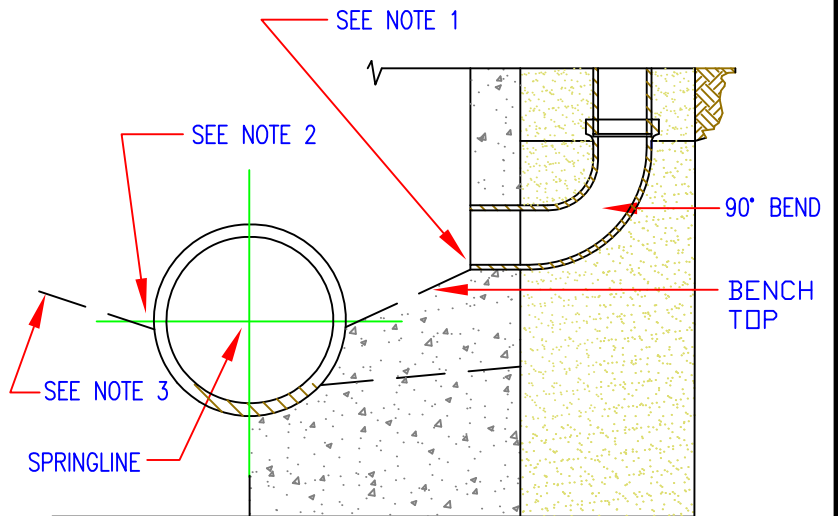

CITY OF OROVILLE
DEPARTMENT OF PUBLIC WORKS

STANDARD FOR
OUTSIDE DROP MANHOLE

DRAWN BY.
SG

RICK WALLS, P.E.
DIRECTOR OF PUBLIC WORKS DEPARTMENT

SHEET
1 OF 1
SS-07