

CITY OF OROVILLE
DEPARTMENT OF PUBLIC WORKS

STANDARD FOR
MANHOLE W/ ECCENTRIC CONE ASSEMBLY

DRAWN BY.
SG

RICK WALLS, P.E.
DIRECTOR OF PUBLIC WORKS DEPARTMENT

SHEET
1 OF 3
SS-02

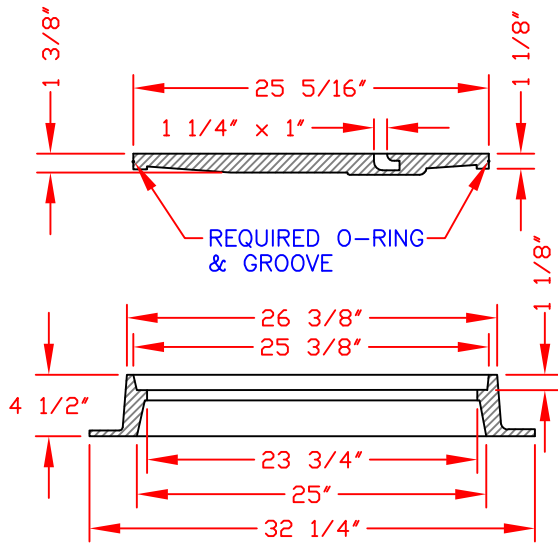

MANHOLE FRAME AND COVER DETAILS

POLYPROPYLENE MANHOLE STEPS. (ASTM C-478)

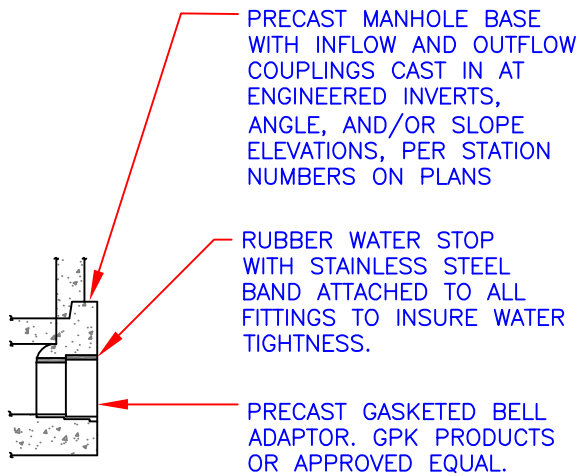
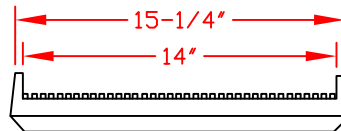
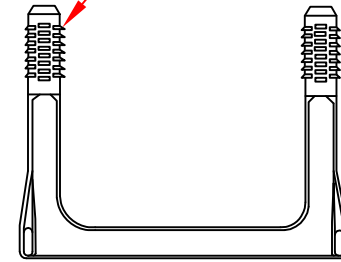

SS PIPE CONNECTION

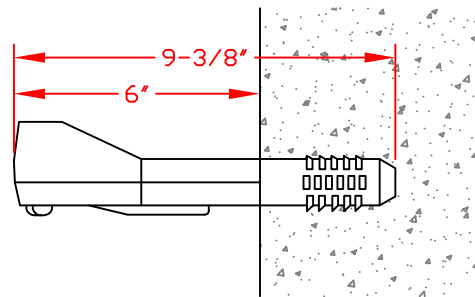

MANHOLE STEP DETAILS



CITY OF OROVILLE
DEPARTMENT OF PUBLIC WORKS

STANDARD FOR
MANHOLE W/ ECCENTRIC CONE ASSEMBLY

DRAWN BY.
SG

RICK WALLS, P.E.
DIRECTOR OF PUBLIC WORKS DEPARTMENT

SHEET
2 OF 3
SS-02

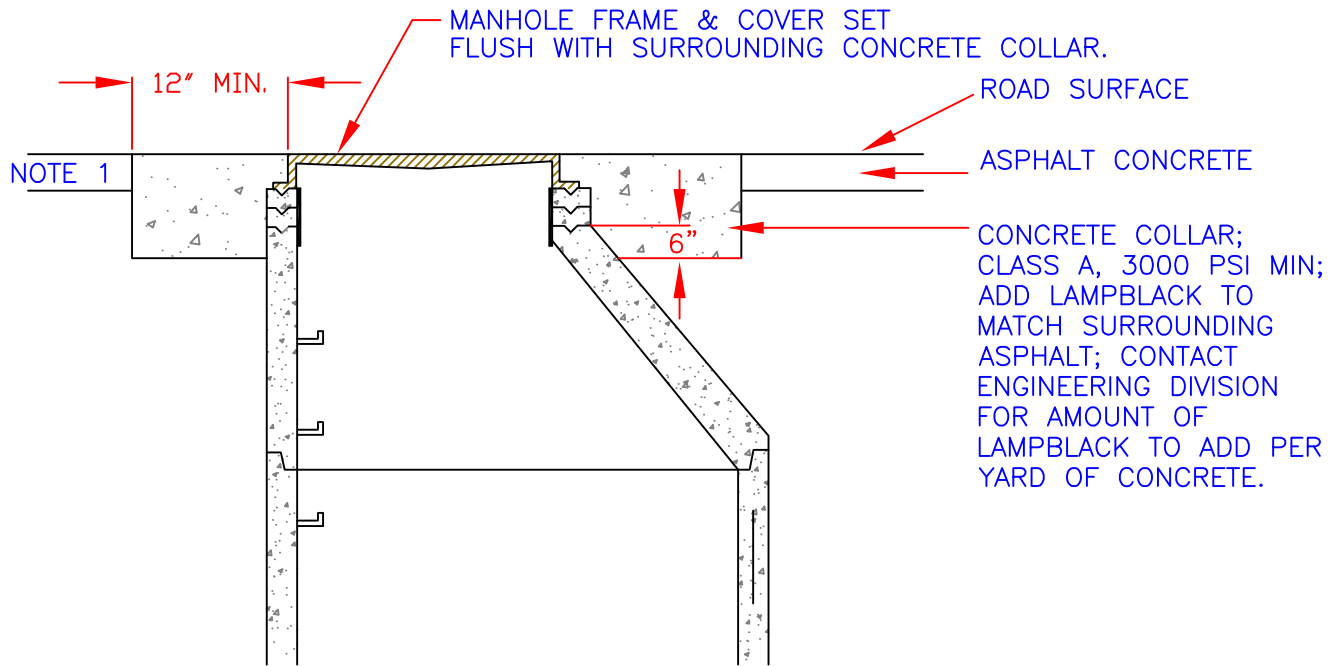

NOTES:

1. 2", 3", 4" OR MATCH EXISTING. REFER TO ENGINEERING DIVISION FOR GUIDANCE.
2. PLACE A MINIMUM OF 24" OF COMPACTED CLASS II AB AROUND MANHOLE PERIMETER, TO BOTTOM OF MANHOLE.
3. USE OF NATIVE MATERIAL BELOW STRUCTURAL ROAD SECTION SHALL BE APPROVED BY THE CITY ENGINEER.



CITY OF OROVILLE
DEPARTMENT OF PUBLIC WORKS

STANDARD FOR
MANHOLE W/ ECCENTRIC CONE ASSEMBLY

DRAWN BY.
SG

RICK WALLS, P.E.
DIRECTOR OF PUBLIC WORKS DEPARTMENT

SHEET
3 OF 3
SS-02